

Note:

- Introduced with Anti-Theft Technology and Fake PIN password function you can input any code(s) before or after the real password to prevent the real password being peeped. Maximum 16 digits.

Special function description

1 > Decode

When password been forgotten, you can get the decode number by providing the code on the lock body to the distributor, the password will be changed to the original "1234" and "4321" ; Or use the pin to press the reset hole at least 3 seconds, the password will get back to factory default. Working mode will be kept.

2 > Auto-alarm will be activated when input wrong password 4 times and the lock will be died for 60s.

3 > Battery low voltage prompts

When the buzzer give out three sounds di di di, and the red indicator light is on mean battery at low voltage, please place the battery in time, the lock may not work when the voltage is low.

4 > Emergency power supply

when the battery is in low voltage condition, you can connect the USB port with an external power supply.

Fixing hole size & installation

▼ Fixing hole size

Unit: mm

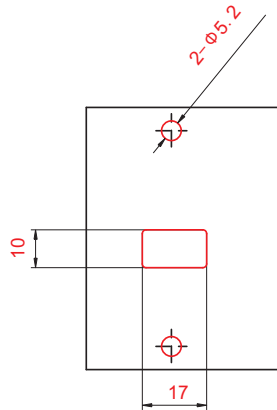

(1)

Metal /Wood panel

▼ Installation Unit: mm

Suitable thickness for wooden door: 16~20mm

Suitable thickness for metal door: 0.6-2mm

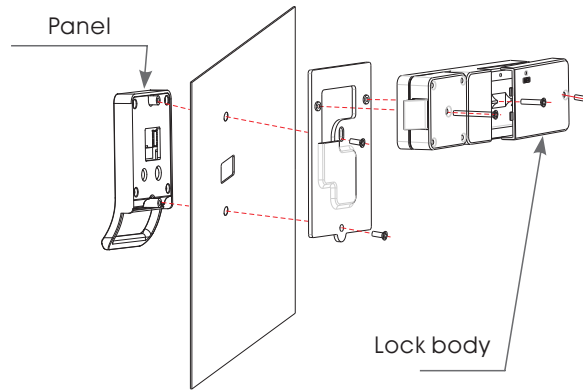

Work manual

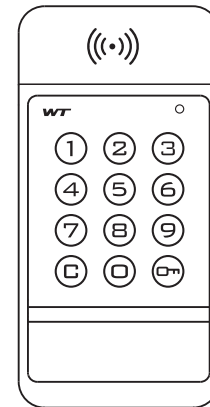

customerservice@tayco.com

Tel: 416-252-8000

Toll Free: 1-800-675-4092

www.tayco.com



产品简介

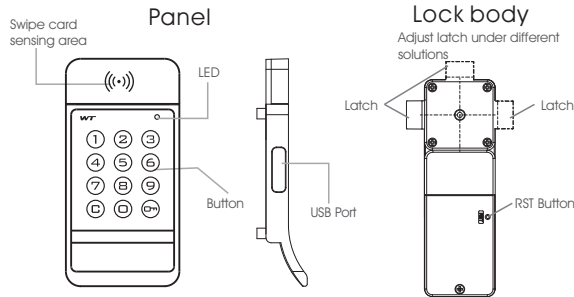

Technical parameters

| | | | |
|---------------------|--------------|---------------------|------------------|
| Management password | 4321 | Management card | 3 |
| User password | 1234 | User card | 20 |
| Working temperature | -20 ~ +55°C | Dynamic current | 130mA |
| Working humidity | 10% ~ 85% RH | Batteries life time | 1 year |
| Storage temperature | -40 ~ +55°C | Power supply | 2 x AA batteries |

How to operate

1. Factory default user code 1234. Factory default management code 4321. Card database is empty, card can not unlock before added.
2. With private mode and public mode, factory default mode is private mode.

Lock & unlock

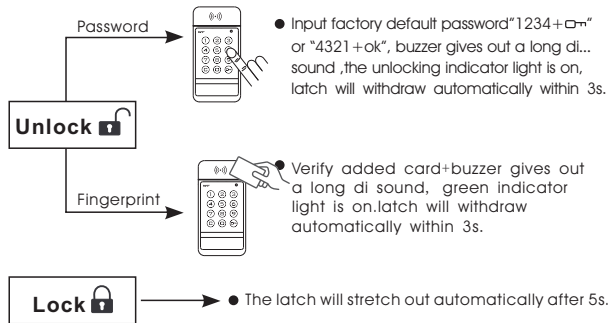

* NOTES:

- When password/card is wrong alarming sound di...di... 3 times
- When buzzer gives out sound di.di.di. 3 times and the red indicator light is on means low voltage.
- When using the management password unlock succeed, user password will be changed back to original password: 1234

Setting password

Change management password

- 1 > Input current management password "4321+C", buzzer gives out a long di... Sound, the green indicator light will flash
- 2 > Input new management password "*****+OK", when you heard a long di... sound means management password already been changed

* NOTE:

- Password can be consisted of 4-15 digits.

Change user password

- 1 > Input current user password, "1234+C", buzzer gives out a long di... sound, the green indicator light will flash
- 2 > Input new user password, "*****+OK", when you heard a long di sound means user password already been changed

* NOTE:

- Password can be consisted of 4-15 digits, pls note that the management password can not be the same as user password

Setting card

How to add management card

- 1 > Input current management password, press "C", buzzer gives out a long di... Sound, the green indicator light will flash,
- 2 > Use card to close to inductive zone, buzzer gives out a long di... sound, addition succeeds, this new card will be management card, you can continue to add other card as management card (3 at most)

How to add user card

- 1 > Use management card 1 time, you will hear a long di... sound and see the green indicator light is on
- 2 > Use management card again, the green indicator light will flash
- 3 > Take any other card to be added, when you heard a long di... sound, this new card will be user card, you can continue to add the other user card (20 at most)

* NOTES:

- Management card is with unlocking and deleting user card function, management card and user card can not be the same card.
- Verify management card, green indicator light twinkle, you can continuous adding cards, the first 3pcs cards are management cards, the following 20pcs cards are user cards.

How to delete single user card

- 1 > Use management card 3 times, you will hear a long di... sound and see the green indicator light will flash quickly,
- 2 > Use user card you want to delete, heard a long di... sound, deletion succeed, you can continue to delete the other user card.

How to delete all cards

- Use management card 5 times, you will hear 2 long di di sound and see the green indicator light will flash quickly and deleted succeed.

How to switch the mode

Turn on public mode, set temporary password

Turn on public mode

- 1 > Input management password + OK, buzzer gives out a long di sound, the green indicator light is on.
- 2 > Press OK at least 2s, the green indicator light flash
- 3 > Input "44", press OK, when you heard a long di sound means public mode already been set.

Set temporary password

- 1 > Input the new password consisted of 4-15 digits
- 2 > Press OK, when you heard a long di sound, the green indicator light is on, temporary password already been set.

Set temporary card

- 1 > Verify any card,
- 2 > when you heard a long di sound, the green indicator light is on, temporary card already been set.

* NOTE:

- After switch to public mode, management card need to be added again,
- Under public mode, management code and management card can delete temporary code, pls well keep it,
- Temporary password/card can be used for 1 time only.
- LED will twinkle every 3s when lock occupied

Turn off public mode

- 1 > Input management password + OK, buzzer gives out a long di sound, the green indicator light is on.
- 2 > Press OK at least 2s, the green indicator light flash
- 3 > Input "43", press OK, when you heard a long di sound means public mode already been turned off

Turn on/off Fake Pin code function

- 1 > Input management password + OK, buzzer gives out a long di sound, the green indicator light is on.
- 2 > Press OK at least 2s, the green indicator light flash
- 3 > Input "42+OK", when you heard a long di sound means Fake Pin code function already been turned on.
Input "41+OK", when you heard a long di sound means Fake Pin code function already been turned off.