

A modern office interior featuring a glass partition and a potted plant. The background is a blurred view of an office space with a glass partition and a potted plant on a shelf.

OFFICE SOLUTIONS FOR

BACK TO WORK

tayco®

A MESSAGE FROM OUR CEO

At Tayco, our priority is to get people back to work safely. As businesses continue to reimagine their work strategy and the role of the office evolves, we continue to take up the challenge of designing solutions that respond to changing client needs and new realities.

What will the new normal office look like? Certainly, there will be an emphasis towards screens and panels between workspaces and less shared workspaces. As companies begin to return to work, we want to help bring people back to work safely with quality, affordable and easy-to-install office solutions designed to keep workers safe without sacrificing form or function.

With a focus on health, immediate actions like re-planning the layout of the office and retrofitting existing future is key for health and wellness.

Kevin Phillips
CEO

tayco[®]

BACK TO WORK



WITH SAFETY & STYLE

Safety is paramount, but it should not come at the cost of function or design.

WHEN ITS TIME TO GO BACK TO WORK, WILL YOUR OFFICE BE READY?

The average workplace will look a lot different in the post-COVID-19 world. While the pandemic has changed the office forever, it's also given us an opportunity to reinvent and reimagine the space like never before.

Workspaces have changed a lot over the years. From the traditional private offices to the semi-private cubicle era to the modern open-concept spaces of today, office design has evolved along with changing employee needs. While open-concept spaces promote creativity, communication, collaboration and social interaction, they are also ideal environments for spreading infectious diseases.

So, how can you make your workplace as safe as possible for everyone? A well-designed, well-sanitized and socially distanced layout is key. With our knowledge and Tayco expertise, we can help keep your employees healthy and productive so that you can continue to work together, continue to see each other, and continue to stay safe.

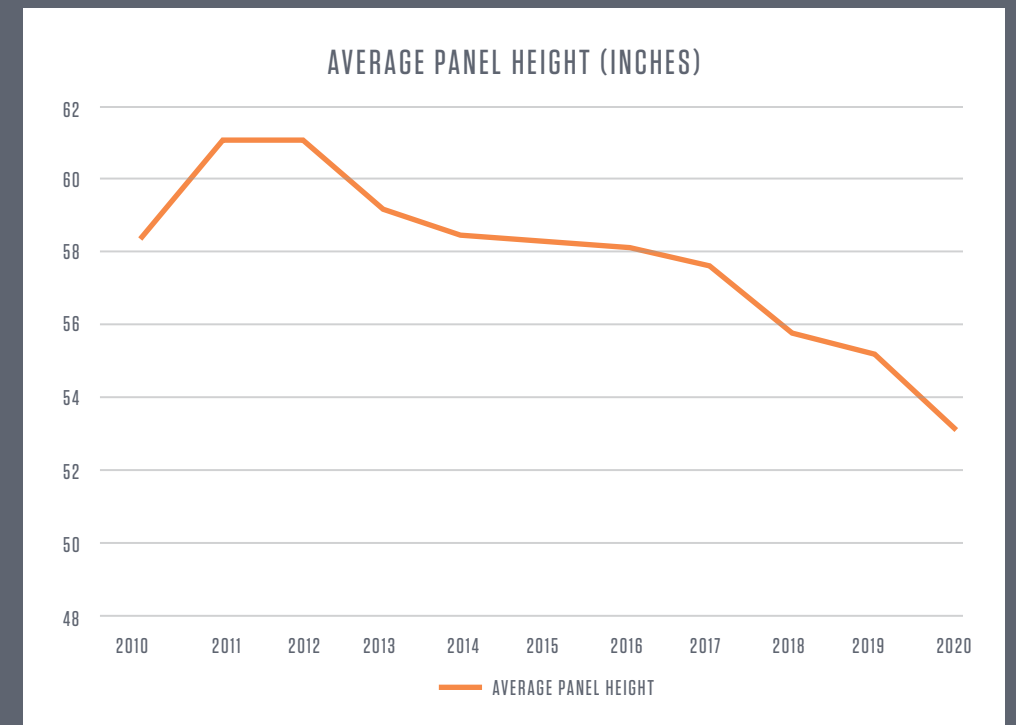

Over the years, companies began to shift towards more flexible and open-concept workspaces and the average panel heights between desks decreased to promote collaboration and open sight lines. However organizations now have a mandate to go back to higher heights to promote better employee health. (Stats gathered by Tayco).



FIRST LINE OF DEFENCE

STAY SAFE, STAY PROTECTED

Decrease density of workspaces, practice social distancing and create policies around consistent office cleaning & health check-ins.

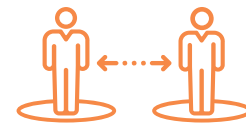

PHYSICAL DISTANCING IS HERE TO STAY

Creating space, separating workspaces when possible, and modifying lunchrooms & meeting rooms to maintain six feet of distance between employees is crucial for a safe office space.



KEEP CHECKING IN

Consider having one entrance for employees & visitors to use, so they can be screened and have temperature checks upon entry. If employees are working from home, virtual check-ins can be set up to gauge the team's health.



CLEAN CONSISTENTLY

Employers should provide employees with disinfectant and wipes to clean work surfaces, chairs and any frequently visited spaces on a daily basis. All furniture should be constructed from easily cleanable non-porous materials, such as laminates, acrylic or glass to make cleaning easier.



UPGRADE VENTILATION SYSTEMS

COVID-19 is spread from person to person via respiratory droplets. While these droplets can remain on surfaces for up to several days, they can also remain in the air for as long as three hours. With this in mind, proper ventilation in office buildings and indoor workplaces must be ensured to help prevent the spread of this airborne disease.



RE-CONFIGURE THE OFFICE

The Centre for Disease Control recommends having partitions between workstations to act as a shield as well as removing and rearranging furniture to create an optimal floor plan that prevents the spread of infectious disease.

MATERIALS MATTER

CLEAN & DISINFECT OFTEN

Non-porous materials, such as glass, acrylic and laminate, are durable, easy to clean and key in preventing the spread of disease in the office.



LAMINATE

- Composite wood covered with a melamine coating
- Available in a wide variety of durable finishes
- Easy to wipe and disinfect



METALS

- Smooth metals, painted with powder coating does not contain crevasses
- Easy to wipe down and disinfect

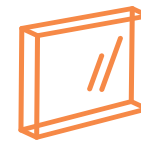

GLASS

- Tempered glass is durable, scratch resistant, remains clear and does not yellow with age.
- According to Kampf et. al., COVID-19 has been proven to survive for a shorter amount of time on glass surfaces compared to plastic products ex. Acrylic
- Easy to clean with a wide range of cleaning products



ACRYLIC (PLEXIGLASS)

- Lightweight & greater impact resistance compared to glass
- Fantastic alternative to glass
- Easy to install
- Easy to clean and disinfect

SHIELD COLLECTION



KEEP YOUR PEOPLE PROTECTED

Re-designing & re-furnishing your office can be extremely costly and take a long time. Instead, look to ways in which you can retrofit your current furniture to prevent the transmission of germs. With the Tayco Shield Collection, our wide range of affordable solutions can help you remodel your space for back to work. The collection also offers the ability to customize with metal components available in all 20 standard metal paint colours.

PANEL SHIELD

Comprised of easy to clean materials, offering approximately 24" of protection above the panel trim, the Panel Shield was designed to help reduce the risk of infection in the workplace. Quick and easy to install, this shield is compatible with most slotted panel systems in the marketplace.



FREESTANDING SHIELD

An exercise in simplicity, the Freestanding Shield is a single element stabilized by a singular steel base. Available in 20+ laminate colours, the shield can be pulled up to any surface, panel or storage piece to create a beautifully architected divisional area, helping to keep you and your team safe.



BLADE SHIELD

Take safety to new heights with the Blade Shield. This universal shield solution can be used on any flat surface or panel trim; an easy to retrofit to any existing set-up. Unlike many other materials, the tempered glass finish is easy to clean, scratch resistant and does not lose colour over time.



SPLITS SHIELD

A sleek, freestanding screen that does not comprise between aesthetics & safety, the Splits Shield provides the ultimate division between coworkers without the need to fasten it to the work surface. Easily move the screen to any location as needed.

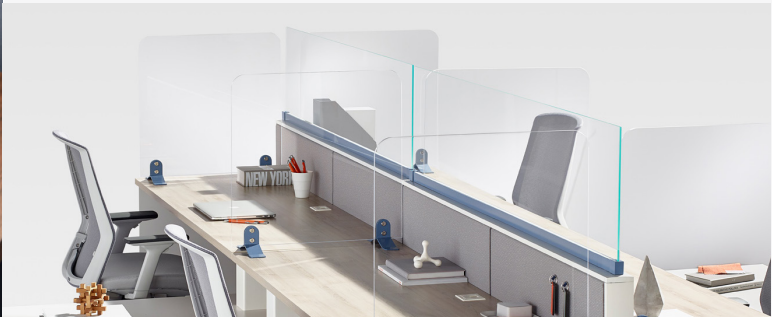

SCENE SHIELD

The Scene Shield, offered at 24" high, is easy to install and can be retrofitted to any current setup. The screens are simply attached with a clamp, avoiding any damage to the surface, or can be permanently fastened with screws. Offered in a wide range of finishes, this is the ideal solution for quickly adding division to an open office.

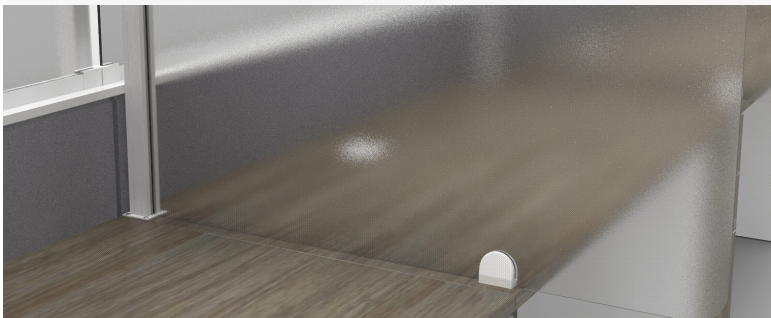

TRANSACTION SHIELD

Stay shielded when greeting visitors and welcoming guests with Tayco's Transaction Shield. The perfect solution to any reception station or frequent visitors desk, this acrylic shield will allow users to converse and pass documents back and forth without compromising safety.

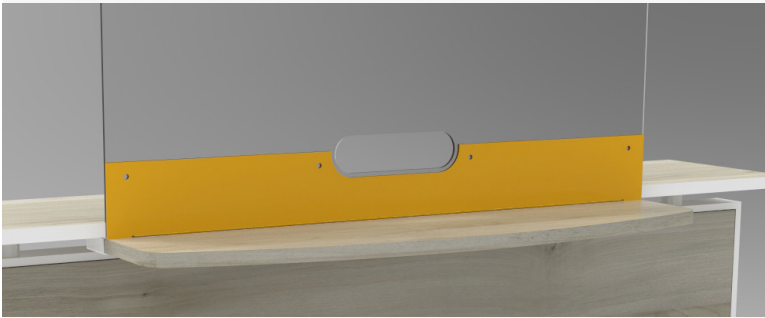

UP SHIELD

Designed to provide the ideal protection for each user, the Up Shield is perfect for any freestanding desk or workspace. At 29" tall, with 24" above the work surface, and 4" below, the Up shield creates a safe & healthy space for employees to work without worry.



DESIGNING HEALTHY FLOOR PLANS



VISITOR SHIELD

Having face-to-face meetings with colleagues and clients is a vital part of the workplace. With the (freestanding) Visitor Shield, you can continue to conduct those important meetings safely. Available at 24" high, this acrylic shield affords the perfect, transparent solution.



RETROFITTING TO PROMOTE SOCIAL DISTANCING

While cubicles & private offices have made way for open-concept workspaces, the modern office is not designed to prevent the spread diseases like the coronavirus.





SCENE SHIELD

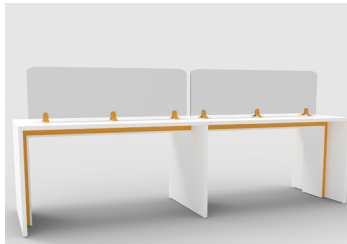

SPLITS SHIELD



FREESTANDING SHIELD



VISITOR SHIELD



PANEL SHIELD



GALLERY SHIELD



PANEL SHIELD

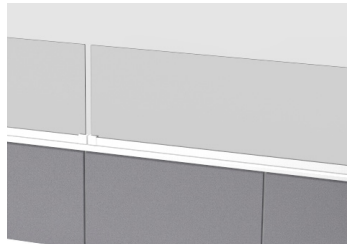

FRAMELESS BLADE



VISITOR SHIELD

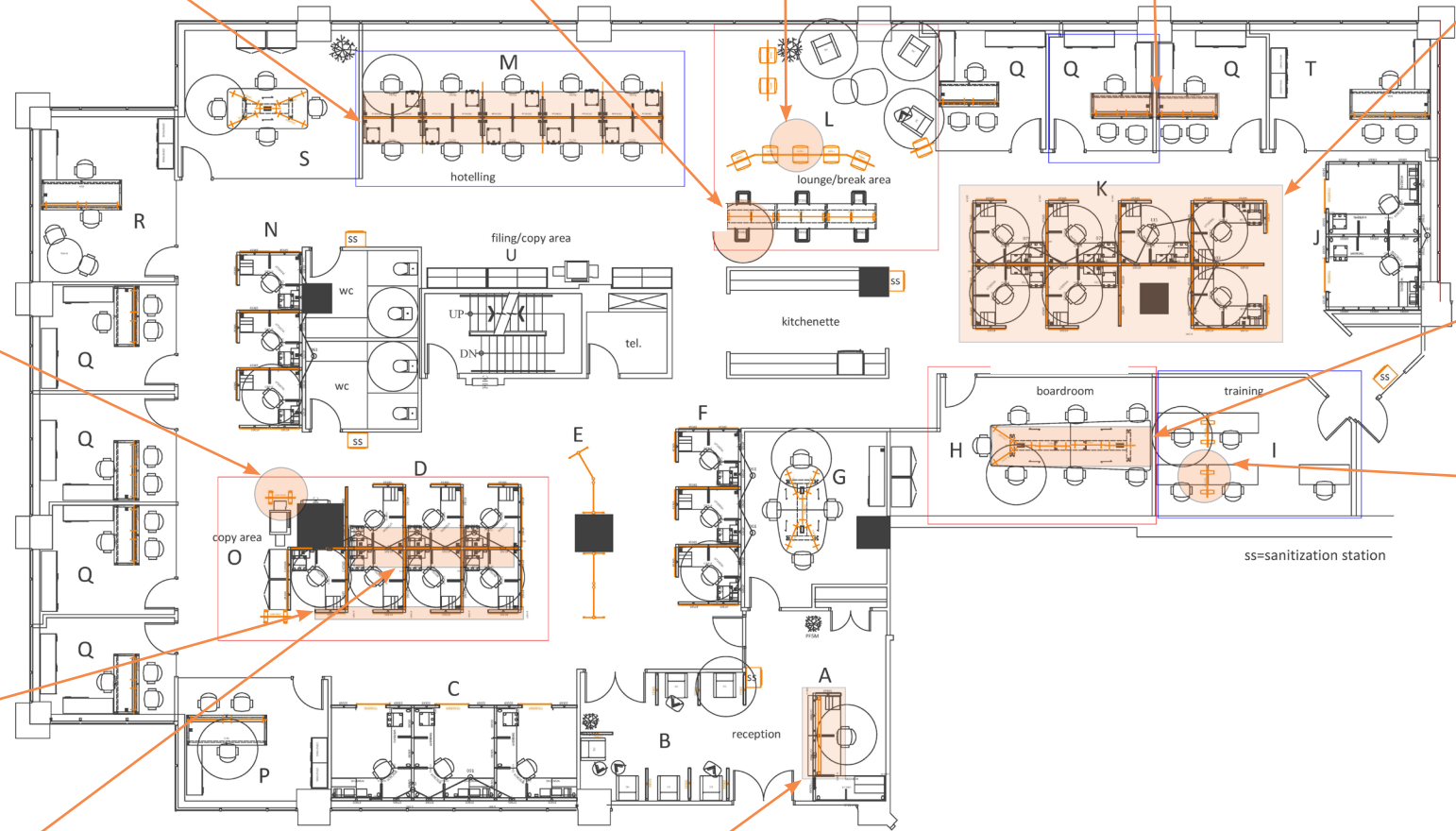

VISITOR SHIELD



GALLERY SHIELD

SAFETY IN THE WORK ENVIRONMENT

All of our models in the Shield Collection are designed to provide personal safety for anyone who shares an office environment, while also maintaining a functional aesthetic and setup. Above we have illustrated how an open concept office floor plan can be equipped with many of our panels and dividers to meet the needs of different areas within a typical working environment.

WORKS CITED

Bannon-Godfrey, R. (2020). 5 ways to achieve a healthier work space now and after-covid-19. Work Place Design Magazine. Retrieved from: <https://www.cbc.ca/news/business/post-pandemic-offices-1.5551308>

Centre for Disease Control. (2020). Interim guidance for businesses and employers responding to coronavirus disease 2019 (covid-19), May 2020. Retrieved from: <https://www.cdc.gov/coronavirus/2019-ncov/community/guidance-business-response.html>

Cushman & Wakefield. (2020). The 6 feet office. Retrieved from: <https://www.cushmanwakefield.com/en/netherlands/six-feet-office>

Gensler (2020). Back to work: Return strategies for the workplace and office buildings. Retrieved from: https://www.gensler.com/uploads/document/694/file/Gensler_Back-to-the-Office-Preview_200515.pdf

Gibben, S. (2020). Goodbye to open office spaces? How experts are rethinking the workspace. National Geographic. Retrieved from: <https://www.nationalgeographic.com/science/2020/04/will-coronavirus-end-the-open-office-floor-plan/>

Kampf, G., Todt, D., Pfaender, S., and Steinmann, E. (2020). Persistence of coronavirus on inanimate surfaces and their inactivation with biocidal agents. Journal of Hospital Infection. 106. 246-251. Retrieved from: <https://www.journalofhospitalinfection.com/action/showPdf?pii=S0195-6701%2820%2930046-3>