

2-Leg Volley Desk

Assembly Instructions

a. Assembly Diagram

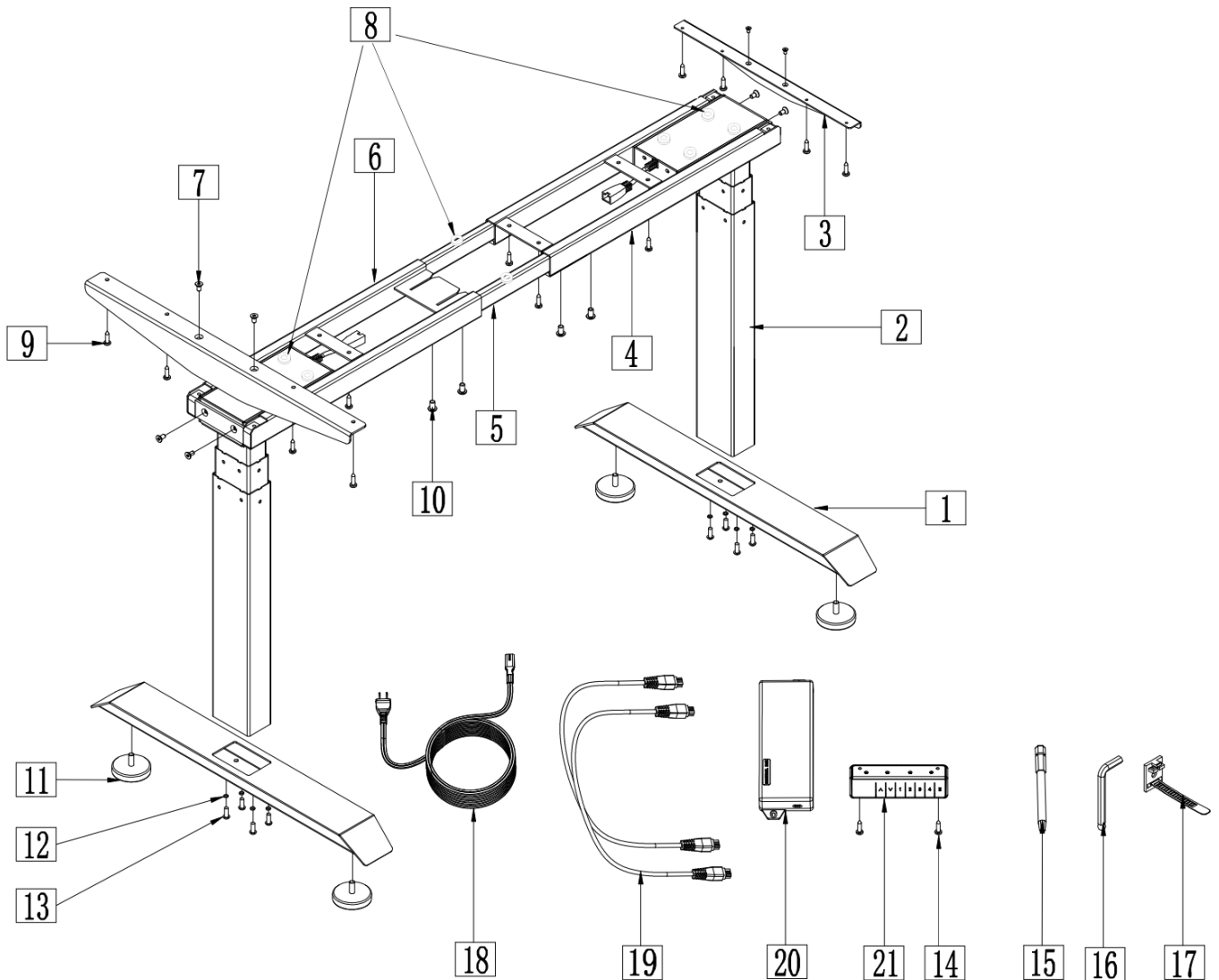

b. Packing list

Base Frame Component

1. Foot	-----	2pcs
2. Lifting Column	-----	2pcs
3. Side Support	-----	2pcs
4. Framework-1	-----	1pcs
5. Extendable Tube	-----	2pcs
6. Framework-2	-----	1pcs

Hardware Components

7. Bolt M6x12	-----	8pcs
8. Rubber Bumper	-----	10pcs
9. Screw #12x3/4	-----	14pcs
10. Bolt M6x10	-----	8pcs
11. Leveling Glides-1"	-----	4pcs
12. Star Washer	-----	8pcs
13. Bolt M6x16	-----	8pcs
14. Screw #8x3/4	-----	7pcs
15. 4mm Hex Bit	-----	1pcs
16. 4mm Hex Wrench- Ball Point	-----	1pcs
17. Cable Tie	-----	5pcs

Electric Components

18. Power Cord-108"	-----	1pcs
19. Patch Cord-59"	-----	2pcs
20. Control Box 2 Outlet	-----	1pcs
21. Handset	-----	1pcs

c. Base Frame Setup.

1. Take out the Framework from carton and extend the outer frame sections.

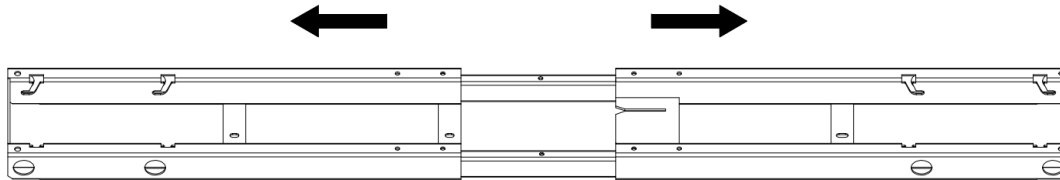
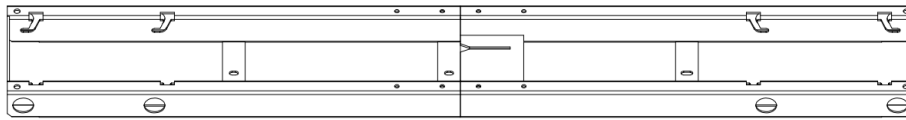

2. Lifting Column is pre-installed with M6x10 bolt. Insert lifting column (Part 2) into the keyway on the Framework (Part 4) then lock in place from the side with Bolt x4 (Part 7, M6x12)

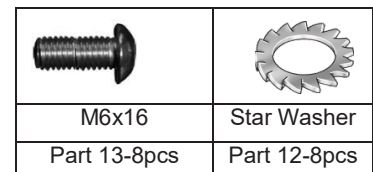
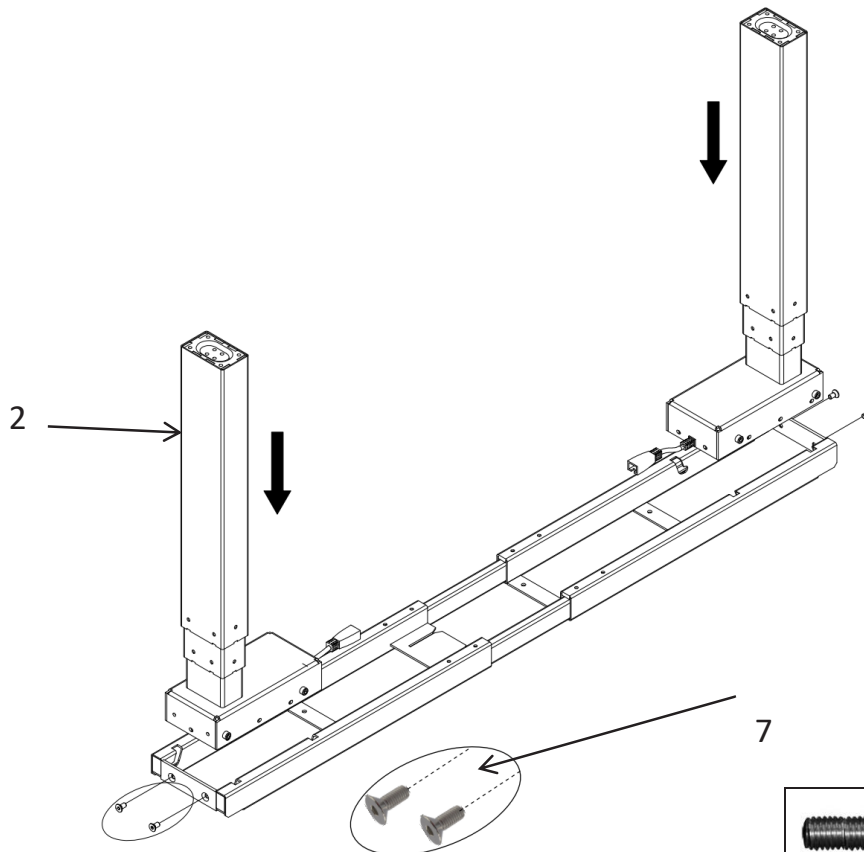

3. Install Leveling Glides x4 (Part 11) to Foot x 2 (Part 1).
4. Install Foot x2 (Part 1) to Lifting Column x2 (Part 2) with Bolt x8 (Part 13, M6x16) and Star Washer x8 (Part 12).

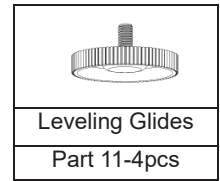
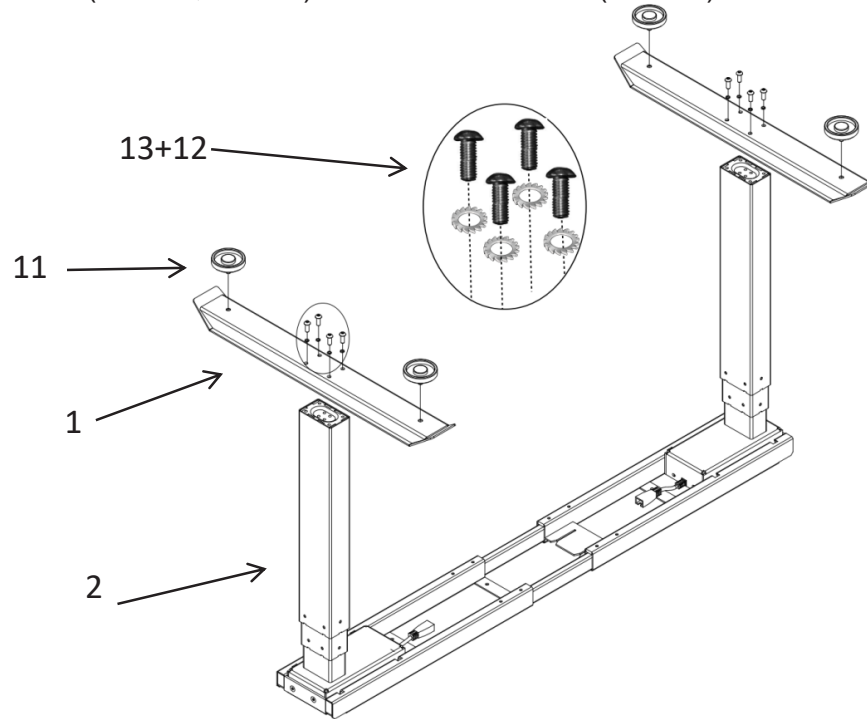

5. Install the Side Support (Part 3) to Framework (Part 4) with Bolt x4 (Part 7, M6x12)
6. Stick Rubber Bumper x10 (Part 8) on top of lifting column and on top of extendable tube.

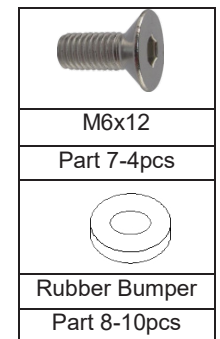
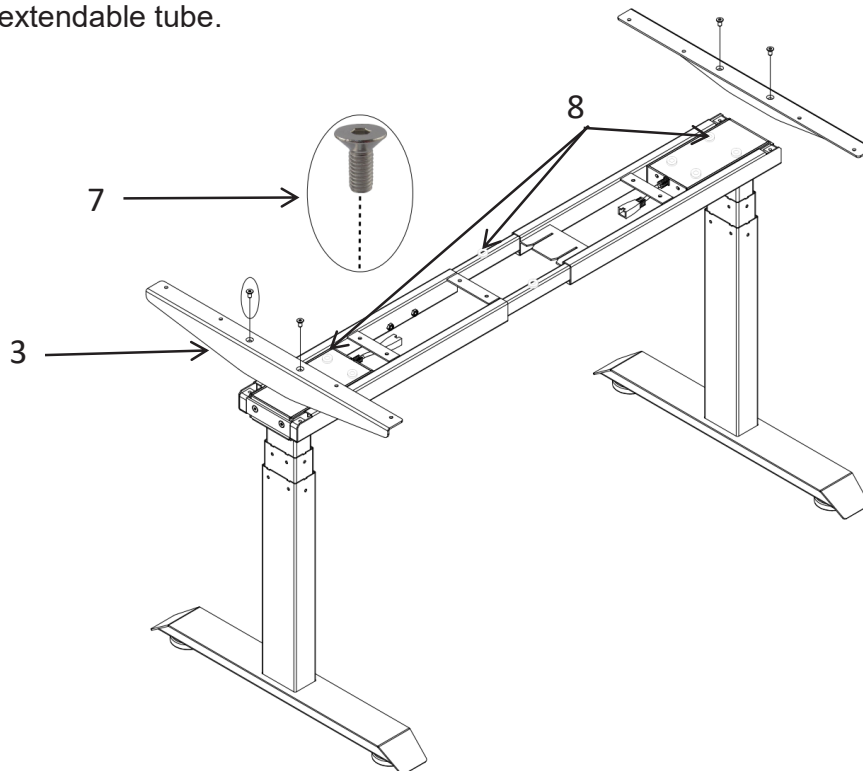

7. Set width of base (DIM B) according to width of tabletop (DIM A) Refer to grid below.
8. Tighten Bolt x8 (Part 10, M6x10) to set the base frame to the correct width.

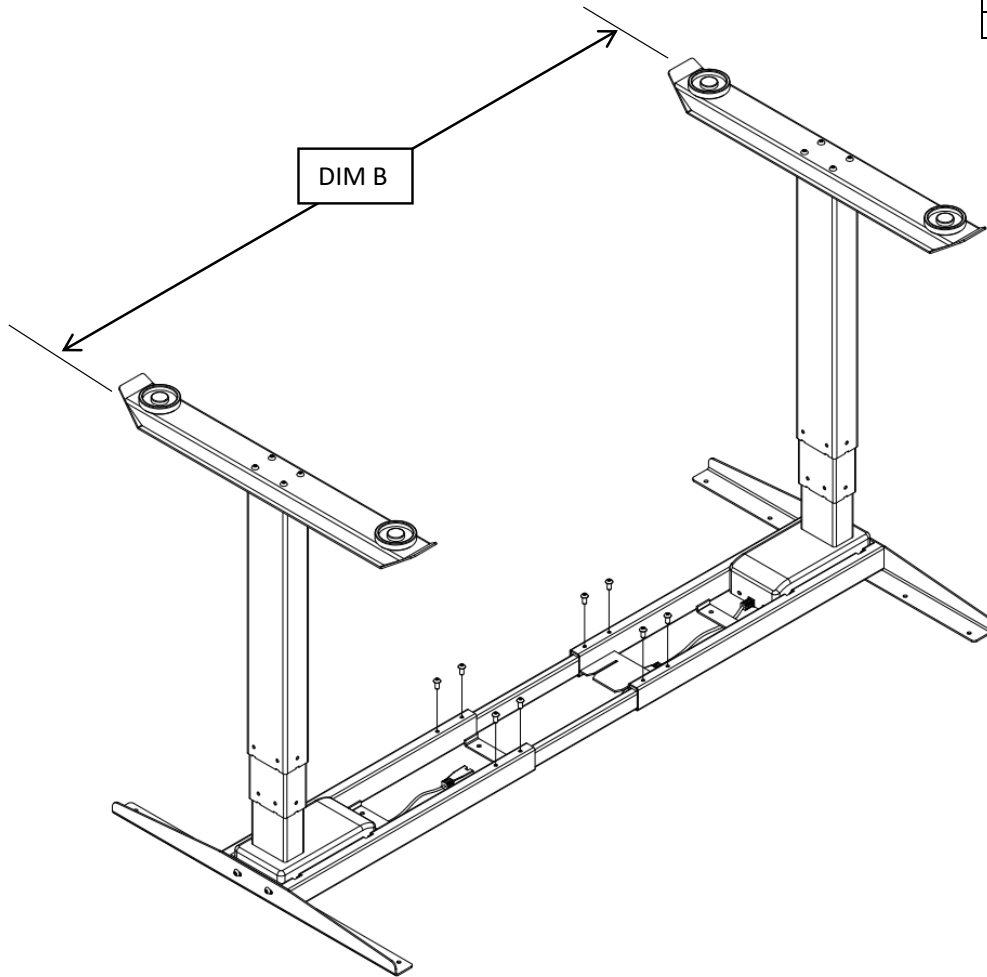
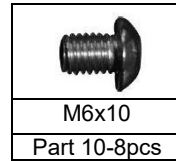

Dimensions	
A	B
Top Width	Base Width
82	71
76	71
70	68
58	56
46	44

9. Hang the Control box x1 (Part 20) on the base.
10. Install Worksurface. Position in the center of top as pictured below.
11. Using Screw x14 (Part 9, #12x3/4) to attach the base to the table top.

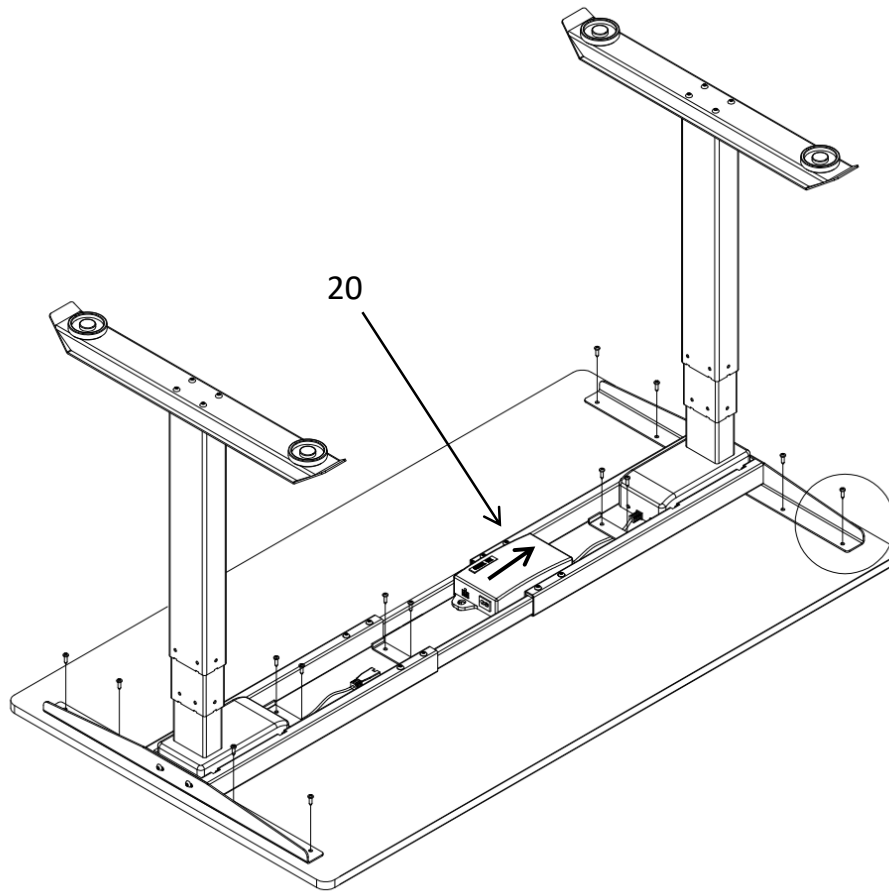
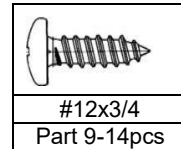

Note: Position Table Frame to on the center of the Worksurface.

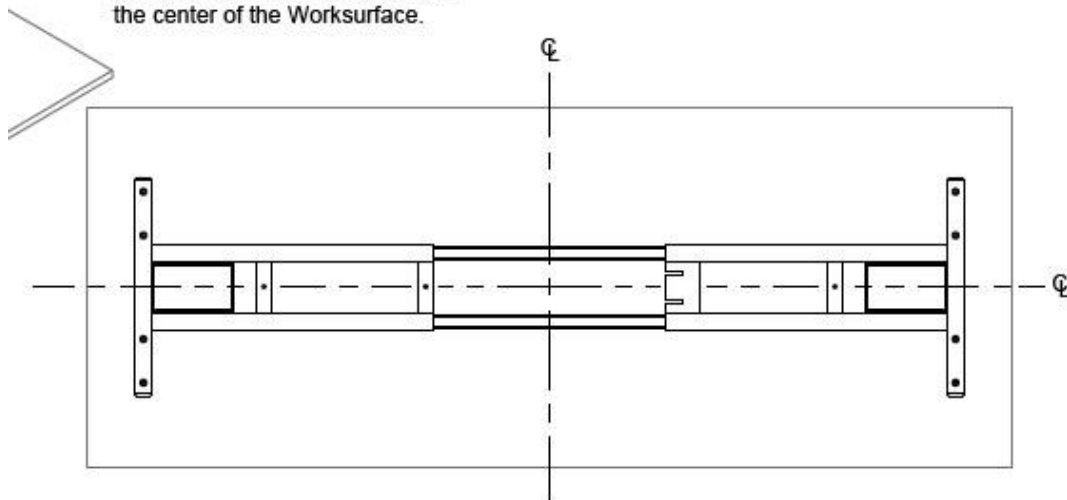

12. Install Handset x1(Part 21) with Screw x2(Part 14,#8x3/4).
Note:Cable Tie can be fixed under worksurface with #8x3/4.

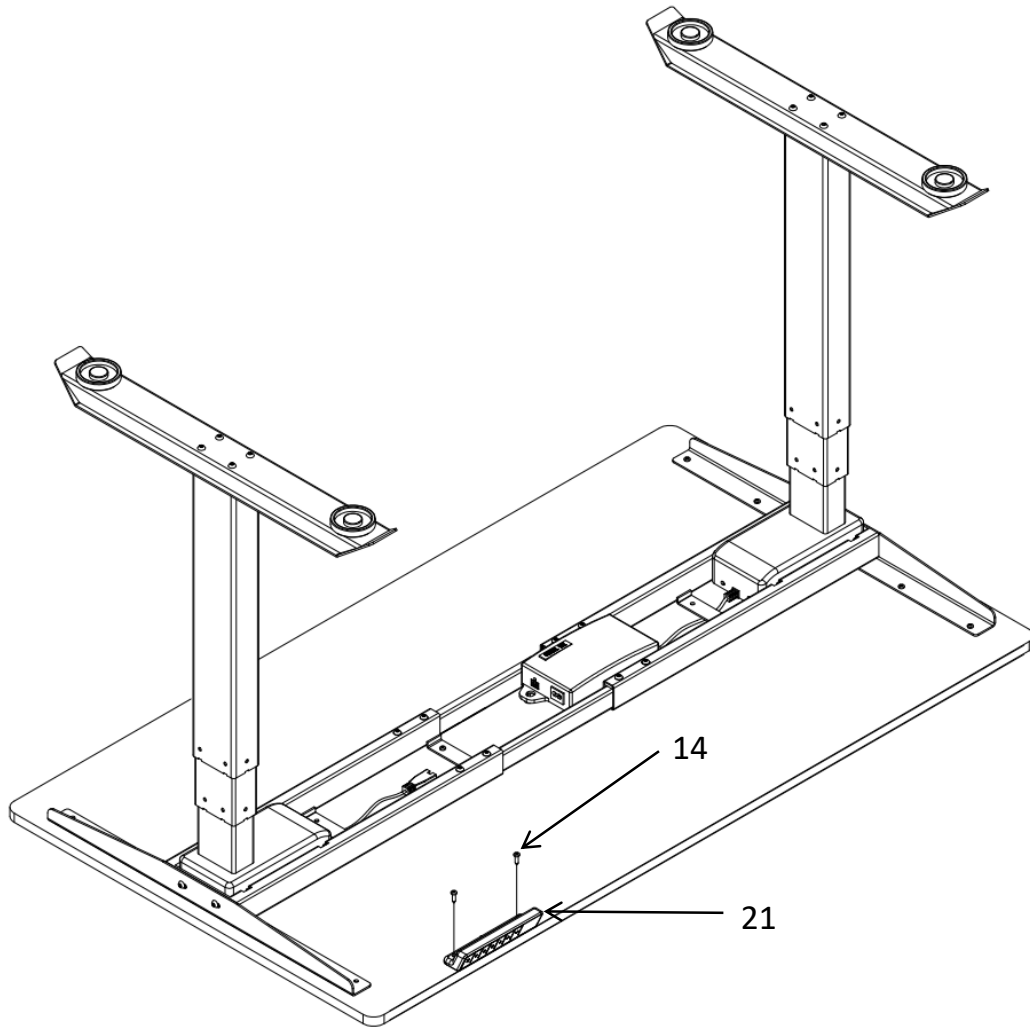
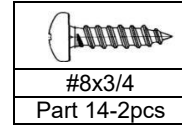

13. Attach Patch Cord x2 (Part 19) to 6 pin connector on Control box (Part 20) and 6 pin connector to Lifting Column x2 (Part 2).
14. Attach Handset RJ45 connector (Part 21) to Control Box switch port (Part 20).
15. Install the Power Cord (Part 18) to Control Box (Part 20).
16. Plug Power Cord into Power Supply. Initialize table by pressing and holding down the down button on the handset for 5 seconds. The handset will display "RES" to confirm the reset command.
17. Table is ready for use. Consult User instructions for more display and calibration options.

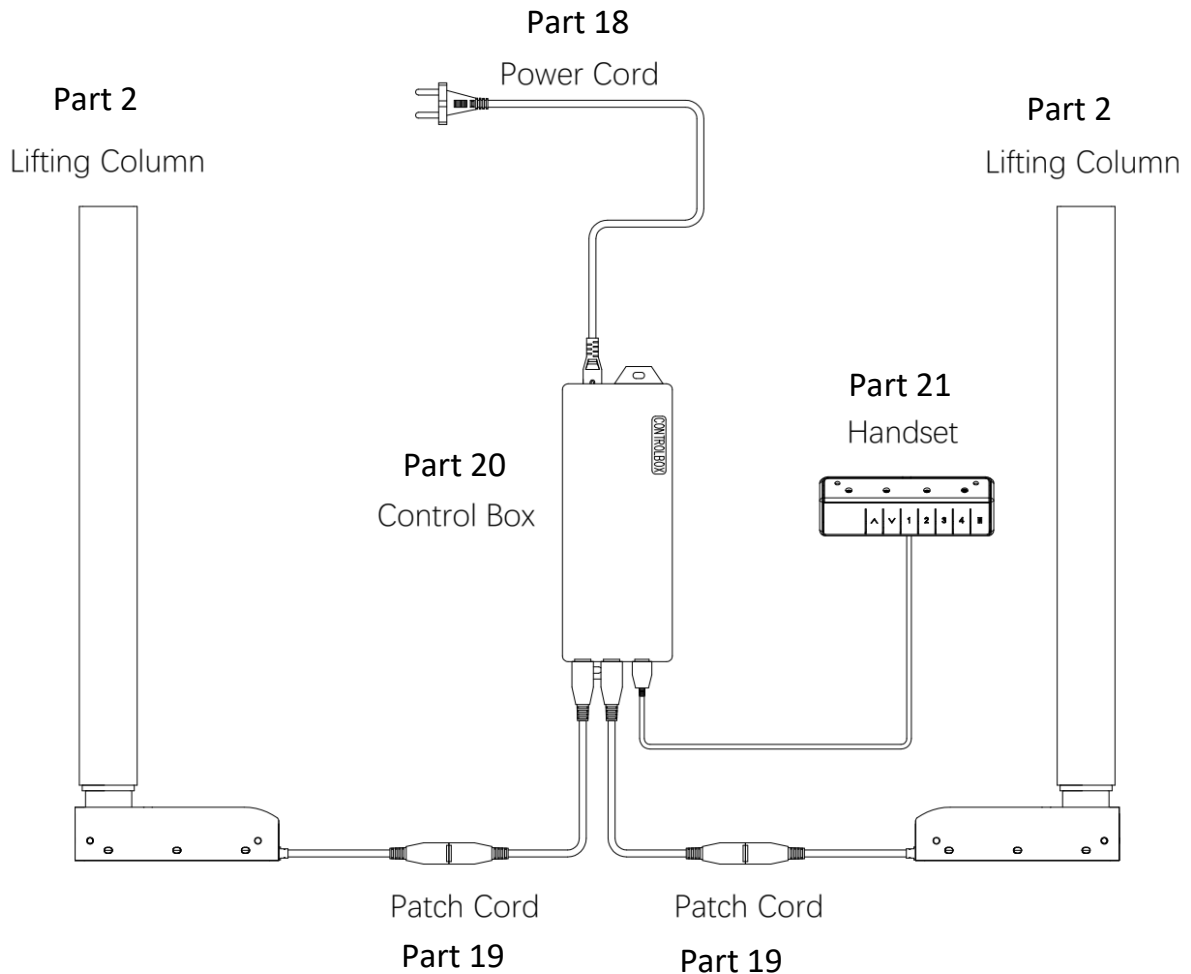



SAFETY NOTICE

Instability Hazard

Mobile items on casters such as flip tops, personal and movable tables of any type, and storage items of any type may present an instability hazard if not secured correctly while in use or storage. Flip-top tables or training tables of any type are inherently more unstable when folded. Tayco provides the following guidelines & warnings when using mobile products:

- Lock casters immediately after moving. Do not leave the casters unlocked when in use or storage.
- Motion may increase the instability of any item with casters. If the wheels hit an obstruction the table's forward momentum often causes overturn, especially if the item is not equipped with wheel extensions. Exercise strong caution while moving these items.
- Use caution when abrupt level changes in the floor are present (such as a doorway or room threshold) as caster failure or tipping may result.
- Do not stand, sit or lean on mobile items for support. They are not intended for this use and personal injury or property damage may result.
- Mobile units that feature height-adjustable elements must be lowered to the minimum compressed height when moving to prevent instability. It is also recommended the user remove all computer equipment or other accessories to prevent possible weight imbalance or damage to equipment.
- Failure to follow the guidelines above may result in property damage or personal injury.

Heavy Load

- Some products must be anchored to the wall to ensure stability & safety.
- It is the owner and installer's responsibility to ensure that the wall type and construction are of sufficient strength to carry loads of any wall-mounted products and their contents.
- Failure of the wall and anchors to support all imposed loads may result in property damage and/or personal injury.
- Tayco can provide the size and empty weight of its products only. A wall blocking is considered a building construction process, Tayco cannot provide recommendations in this respect and cannot be responsible for damage or injury that may occur as a result of improper installation and/or blocking.

Load Bottom Drawer First!

- Operate one drawer at a time.
- Units may tip if loaded incorrectly.
- Units should be attached to a wall or other furniture to reduce tipping hazards.
- Always load the heaviest files in the bottom drawer.

3-LEG VOLLEY DESK - UNDER 46"D

ASSEMBLY INSTRUCTIONS

STEP 1: Take out the Framework pieces from carton and extend the outer frame sections.

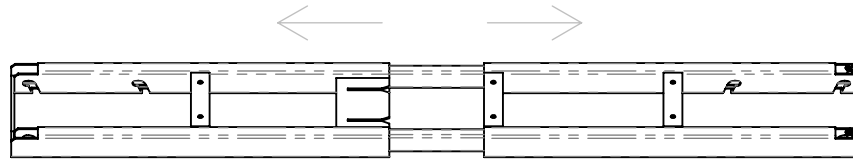

STEP 2: Insert Lifting column into frame keyway leaving pre-installed bolts M6x10 in place. Lock lifting column into frame by installing with M6x12 bolts (x6).

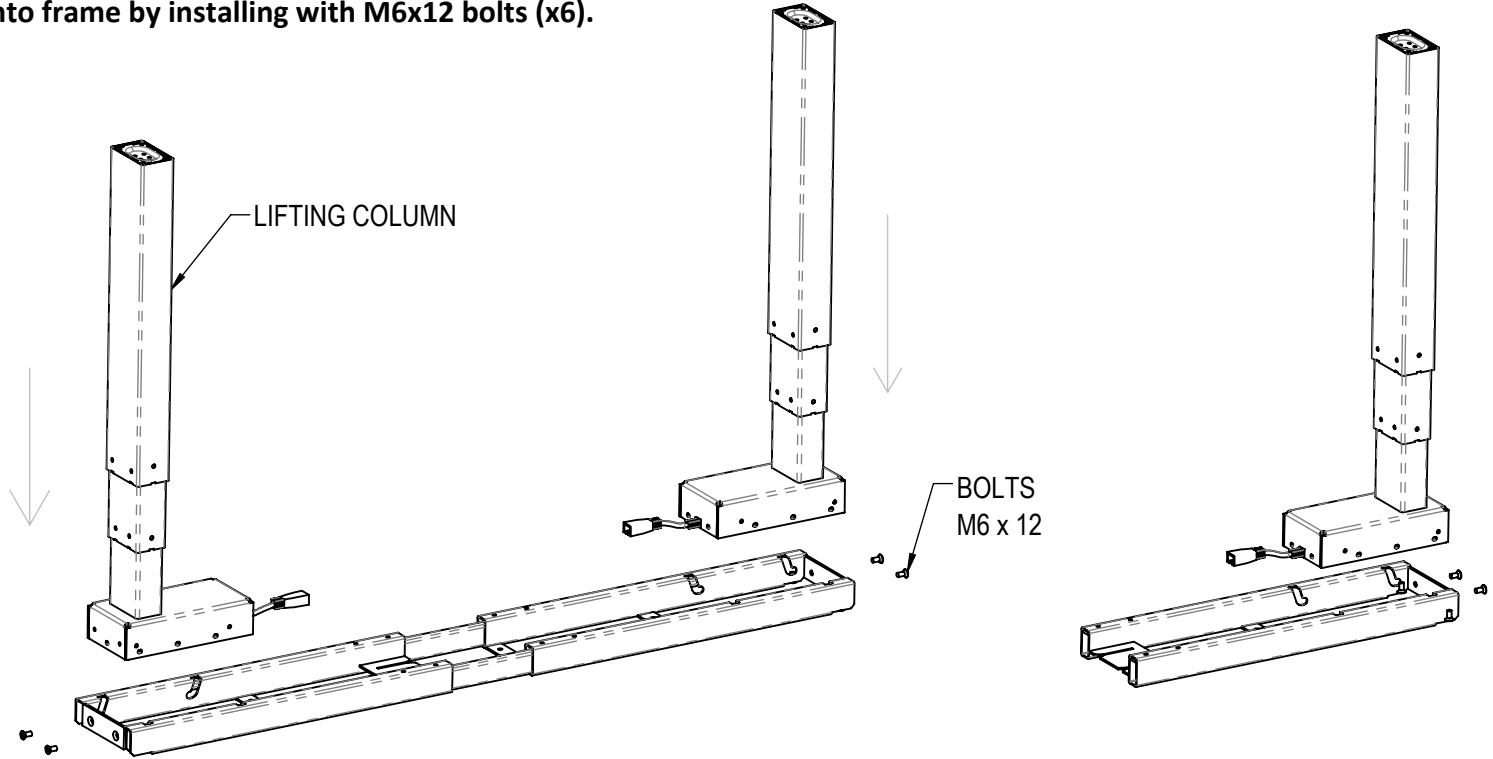

STEP 3: Install leveling glides (x6) to foot (x3).

STEP 4: Install foot (x2) to lifting column and foot (x1) with lifting column. Secure with M6x16 bolts (x12) and star washer (x12).

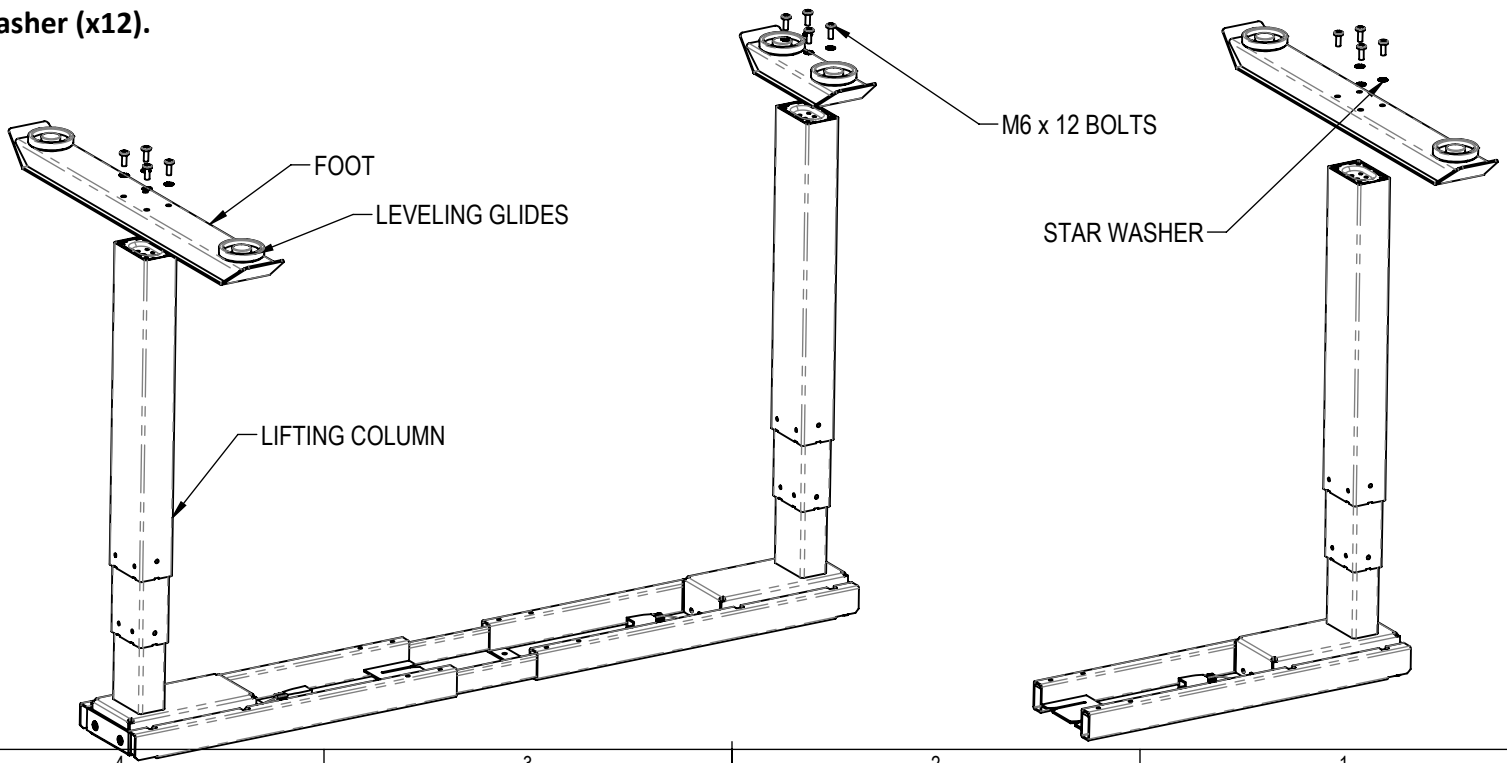

4 3 2 1

3 LEG QUICK CONNECT DESK - UNDER 46"D

ASSEMBLY INSTRUCTIONS

F

STEP5: Install the side support to framework with M6x12 bolts (x6).

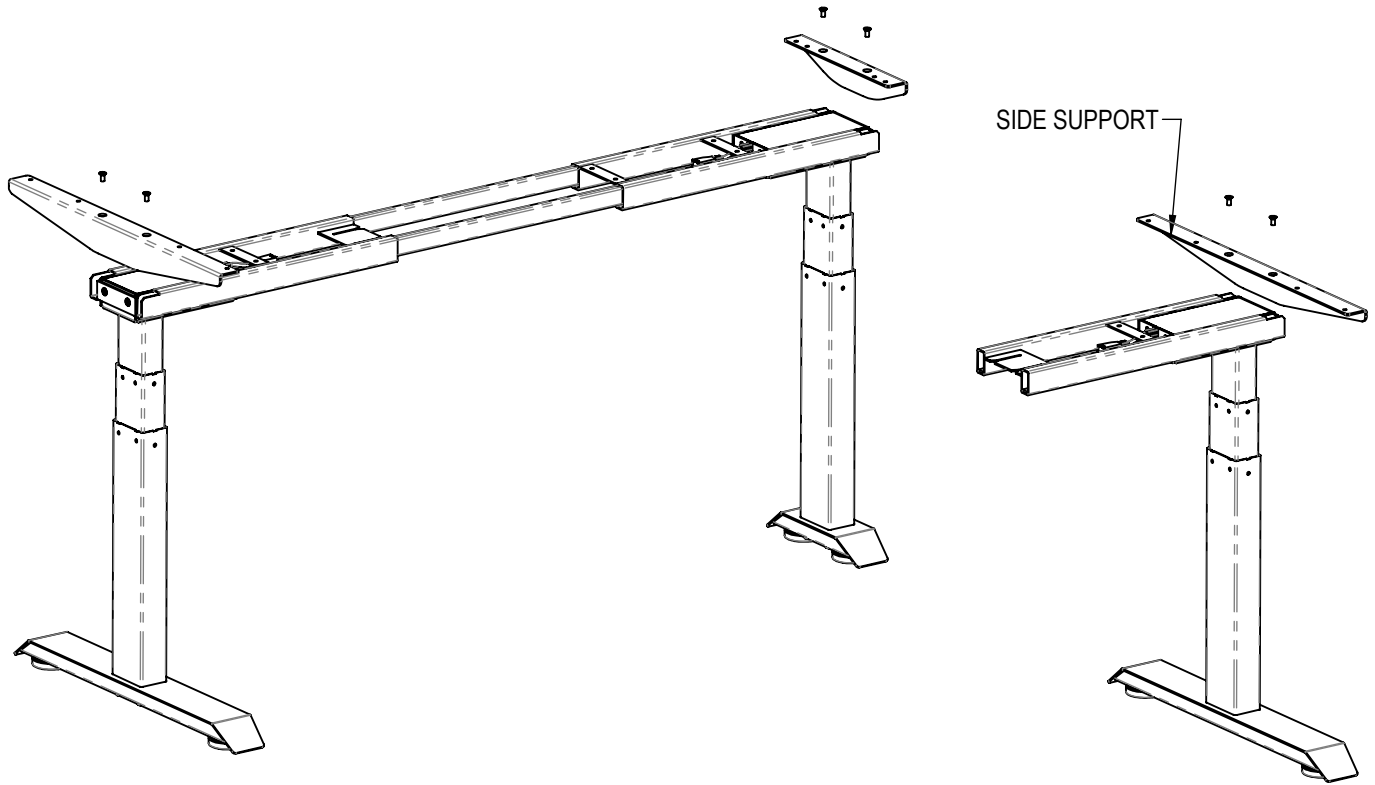

C

STEP 6: Set width of base according to the width of the table top. Tighten M6x10 bolts (x8) to set the base frame to the correct width.

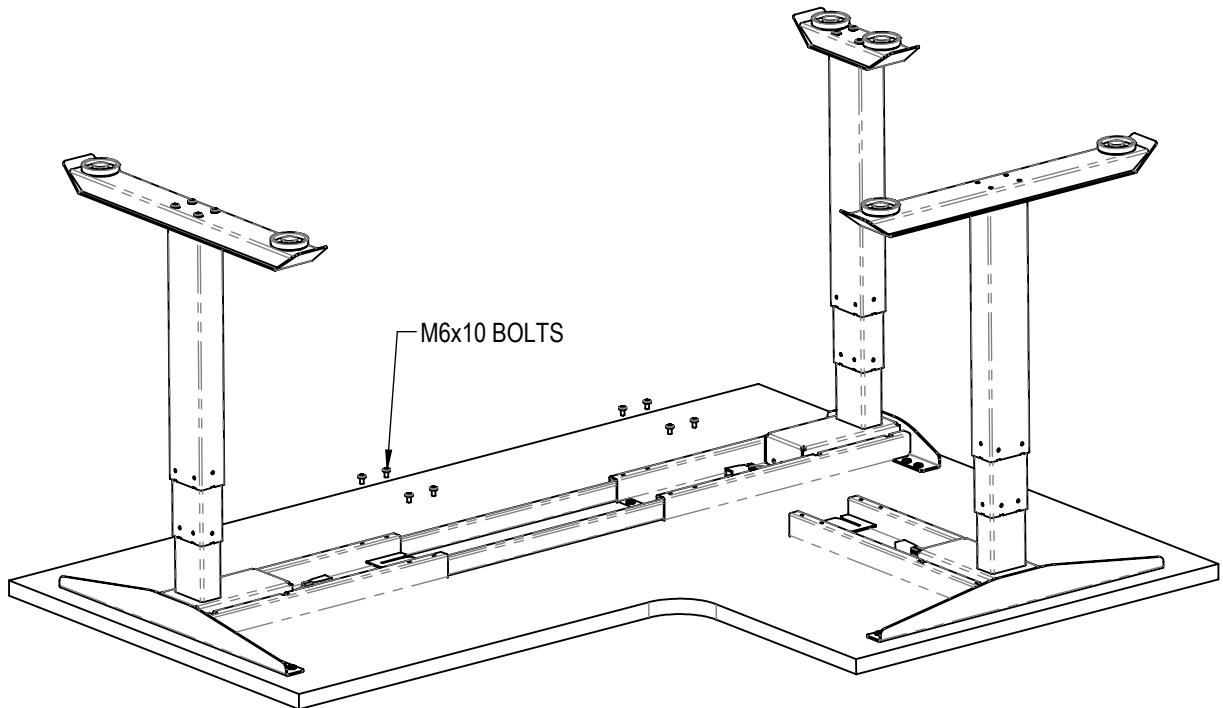

4

3

2

1

3 LEG QUICK CONNECT DESK - UNDER 46"D ASSEMBLY INSTRUCTIONS

STEP 7: Hang the control box on the base. Stick rubber bumper on top of lifting column and extendable tube. Using 1/4-20x3/4 screws (x24) to attach the base to the table top.

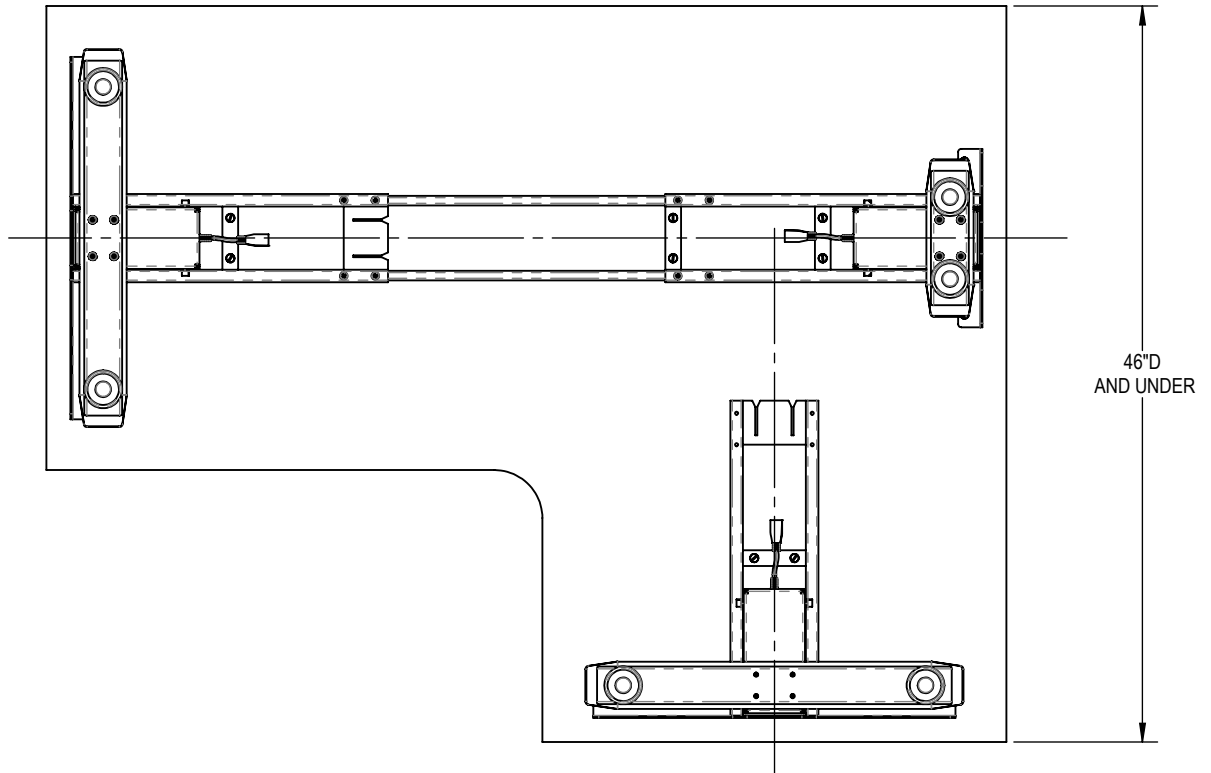
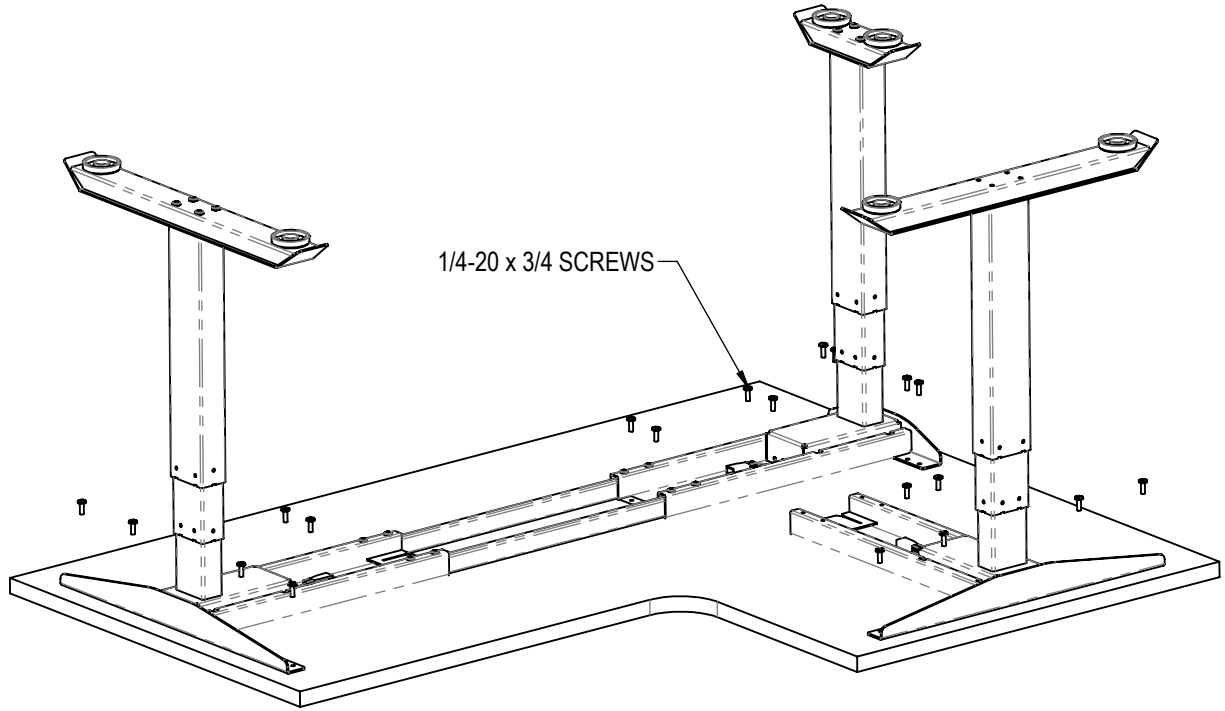

4

3

2

1



SAFETY NOTICE

Instability Hazard

Mobile items on casters such as flip tops, personal and movable tables of any type, and storage items of any type may present an instability hazard if not secured correctly while in use or storage. Flip-top tables or training tables of any type are inherently more unstable when folded. Tayco provides the following guidelines & warnings when using mobile products:

- Lock casters immediately after moving. Do not leave the casters unlocked when in use or storage.
- Motion may increase the instability of any item with casters. If the wheels hit an obstruction the table's forward momentum often causes overturn, especially if the item is not equipped with wheel extensions. Exercise strong caution while moving these items.
- Use caution when abrupt level changes in the floor are present (such as a doorway or room threshold) as caster failure or tipping may result.
- Do not stand, sit or lean on mobile items for support. They are not intended for this use and personal injury or property damage may result.
- Mobile units that feature height-adjustable elements must be lowered to the minimum compressed height when moving to prevent instability. It is also recommended the user remove all computer equipment or other accessories to prevent possible weight imbalance or damage to equipment.
- Failure to follow the guidelines above may result in property damage or personal injury.

Heavy Load

- Some products must be anchored to the wall to ensure stability & safety.
- It is the owner and installer's responsibility to ensure that the wall type and construction are of sufficient strength to carry loads of any wall-mounted products and their contents.
- Failure of the wall and anchors to support all imposed loads may result in property damage and/or personal injury.
- Tayco can provide the size and empty weight of its products only. A wall blocking is considered a building construction process, Tayco cannot provide recommendations in this respect and cannot be responsible for damage or injury that may occur as a result of improper installation and/or blocking.

Load Bottom Drawer First!

- Operate one drawer at a time.
- Units may tip if loaded incorrectly.
- Units should be attached to a wall or other furniture to reduce tipping hazards.
- Always load the heaviest files in the bottom drawer.

3-Leg Volley Desk Assembly Instructions

a. Assembly Diagram

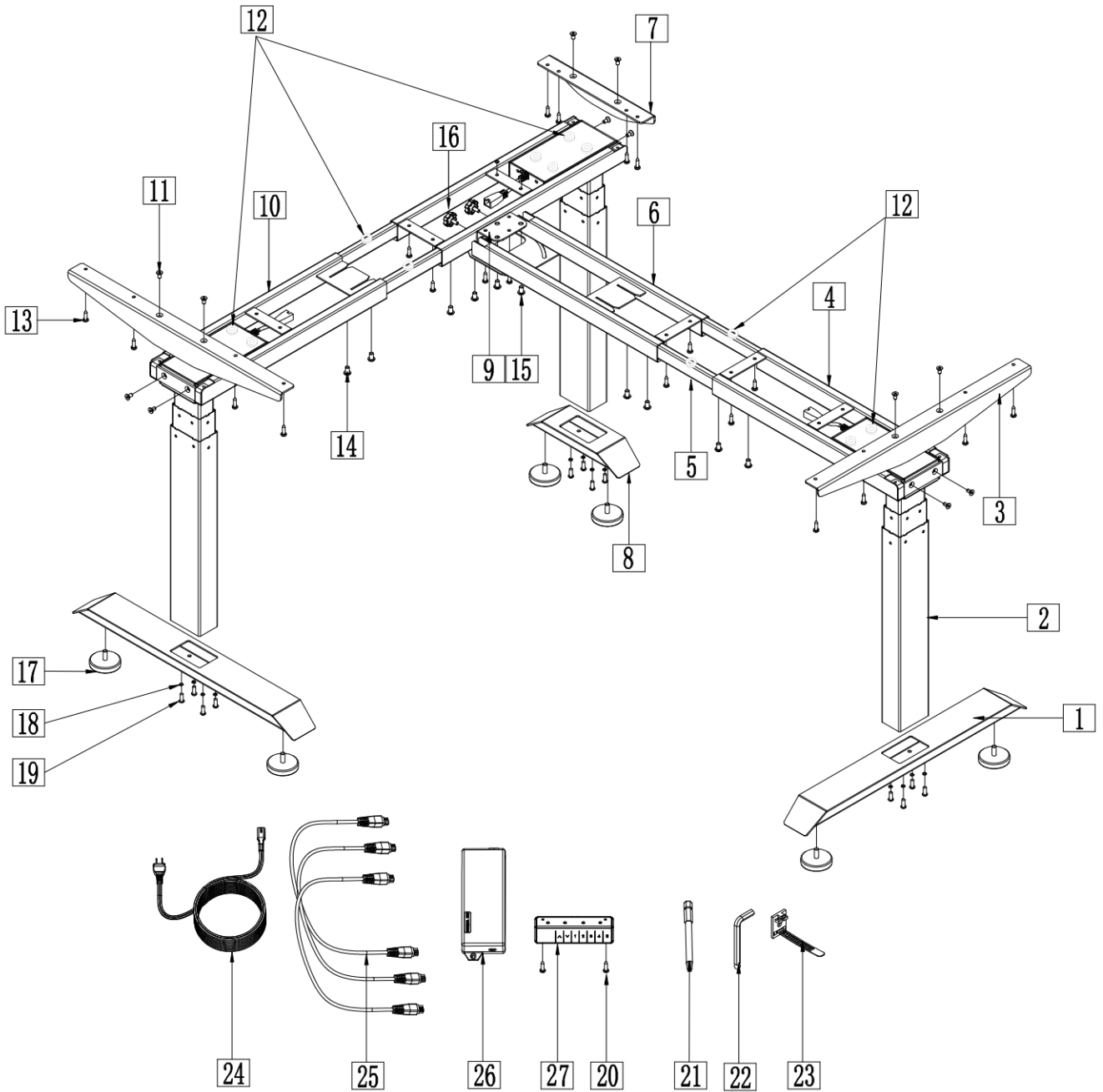

b. Packing list

Base Frame Component

- 1. Foot-Long ----- 2pcs
- 2. Lifting Column ----- 3pcs
- 3. Side Support-Long ----- 2pcs
- 4. Framework-1 ----- 2pcs
- 5. Extendable Tube ----- 6pcs
- 6. Framework-2 ----- 1pcs
- 7. Side Support-Short ----- 1pcs
- 8. Foot-Short ----- 1pcs
- 9. 3rd leg Bracket ----- 1pcs
- 10. Framework-3 ----- 1pcs

Hardware Components

- 11. Bolt M6x12 ----- 12pcs
- 12. Rubber Bumper ----- 16pcs
- 13. Screw #12x3/4 ----- 27pcs
- 14. Bolt M6x10 ----- 18pcs
- 15. Bolt 1/4-20x3/4 ----- 3pcs
- 16. Thumb Screw M6x16 ----- 2pcs
- 17. Leveling Glides-1" ----- 6pcs
- 18. Star Washer ----- 14pcs
- 19. Bolt M6x16 ----- 12pcs
- 20. Screw #8x3/4 ----- 7pcs
- 21. 4mm Hex Bit ----- 1pcs
- 22. 4mm Hex Wrench-
Ball Point ----- 1pcs
- 23. Cable Tie ----- 5pcs

Electric Components

- 24. Power Cord-108" ----- 1pcs
- 25. Patch Cord-59" ----- 3pcs
- 26. Control Box ----- 1pcs
- 27. Handset ----- 1pcs



c. How to Set Up the Base Frame.

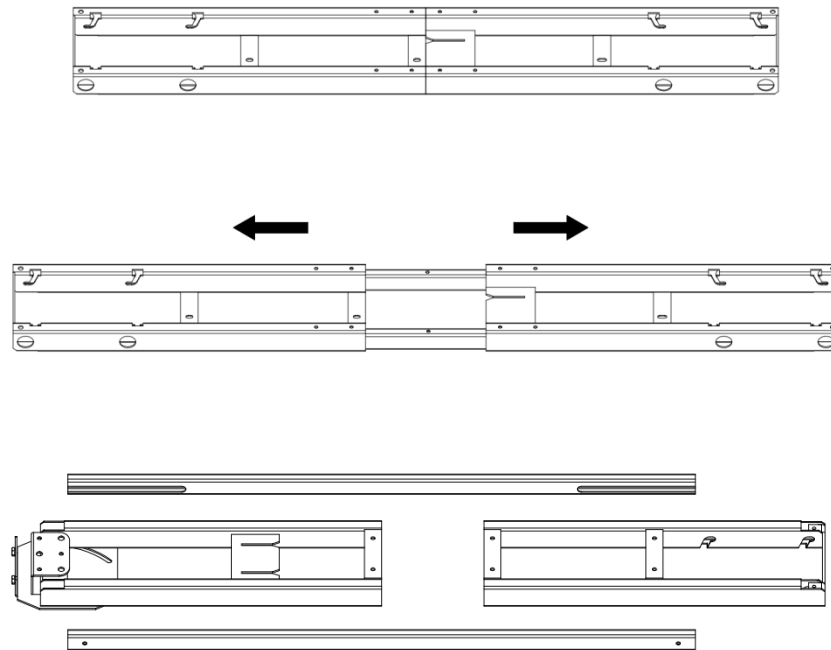

1. Take out the Framework pieces from carton and extend the outer frame sections.

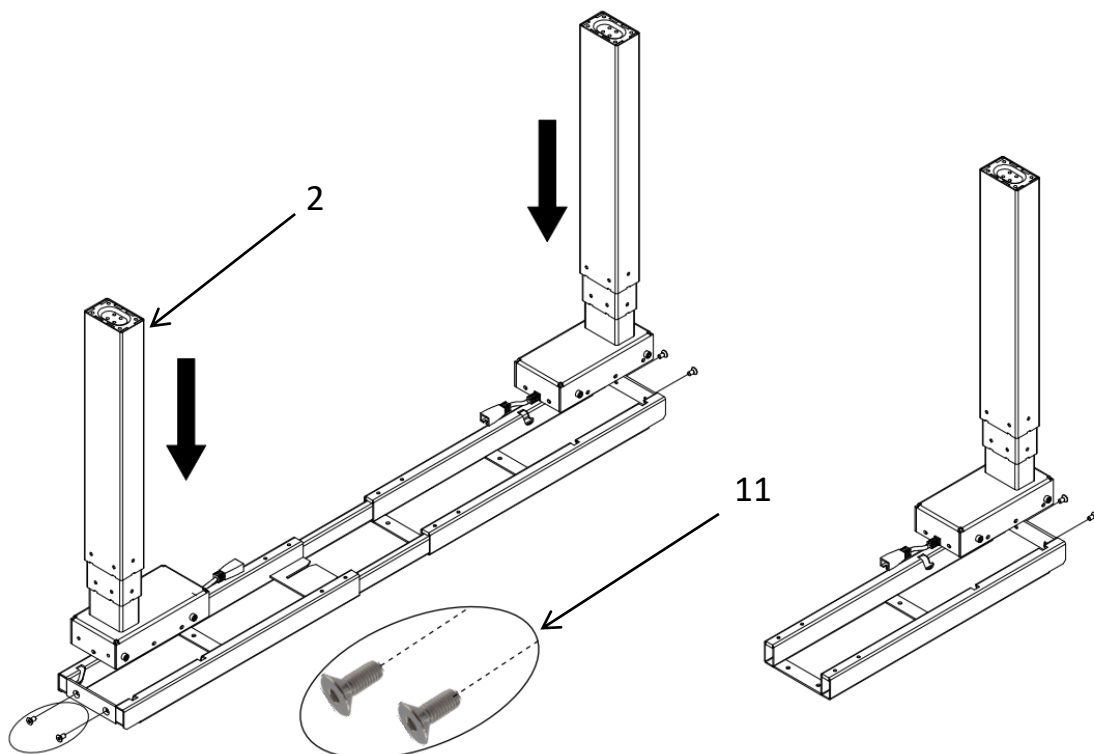

2. Insert Lifting Column into frame keyway leaving pre-installed bolts M6x10 in place, Lock lifting column (Part 2) into frame by installing with Bolt x6 (Part 11, 6pcs)



3. Install Leveling Glides x6(Part 11) to Foot x 3.
4. Install Foot x2 (Part 1) to Lifting Column (Part 2) and Foot x1(Part 8) with lifting column (Part 2). Secure with Bolts x12(Part19,M6x16) and Star Washer x12(Part 18).

	
M6x16	Star Washer
Part 19-12pcs	Part 18-12pcs

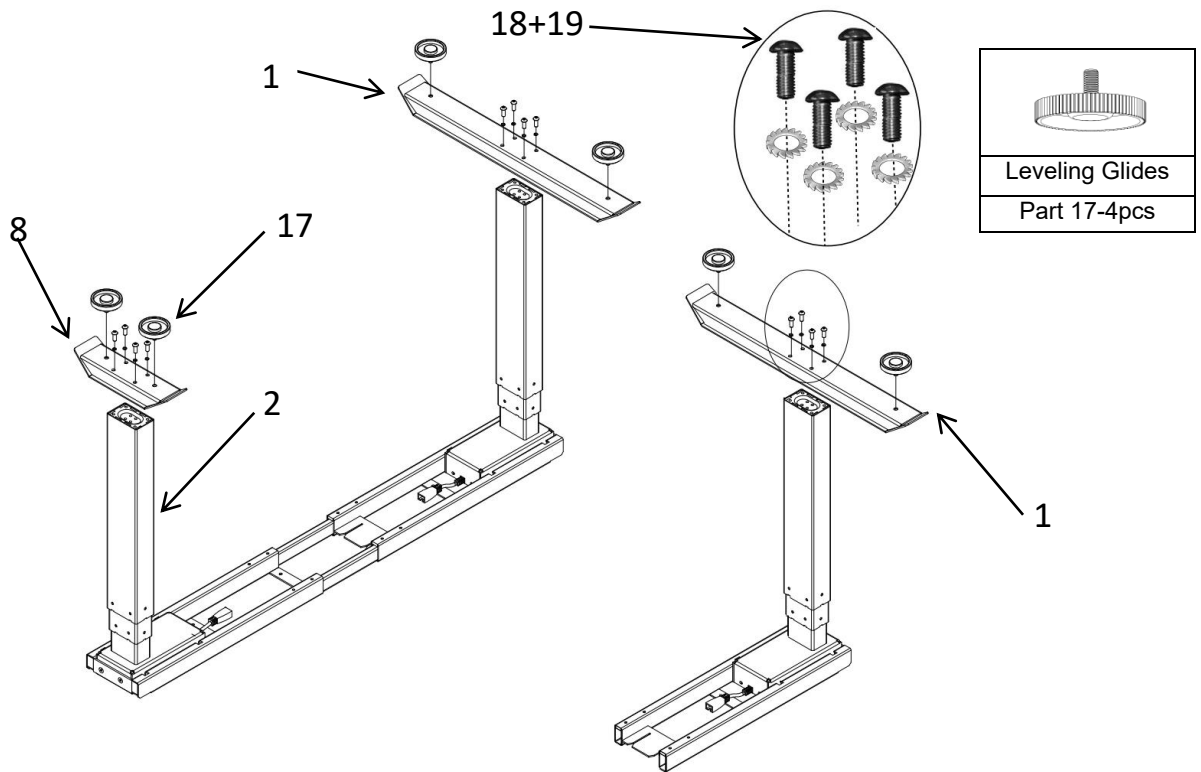

5. Install the Side Support to Framework with Bolt x6(Part 11,M6x12),

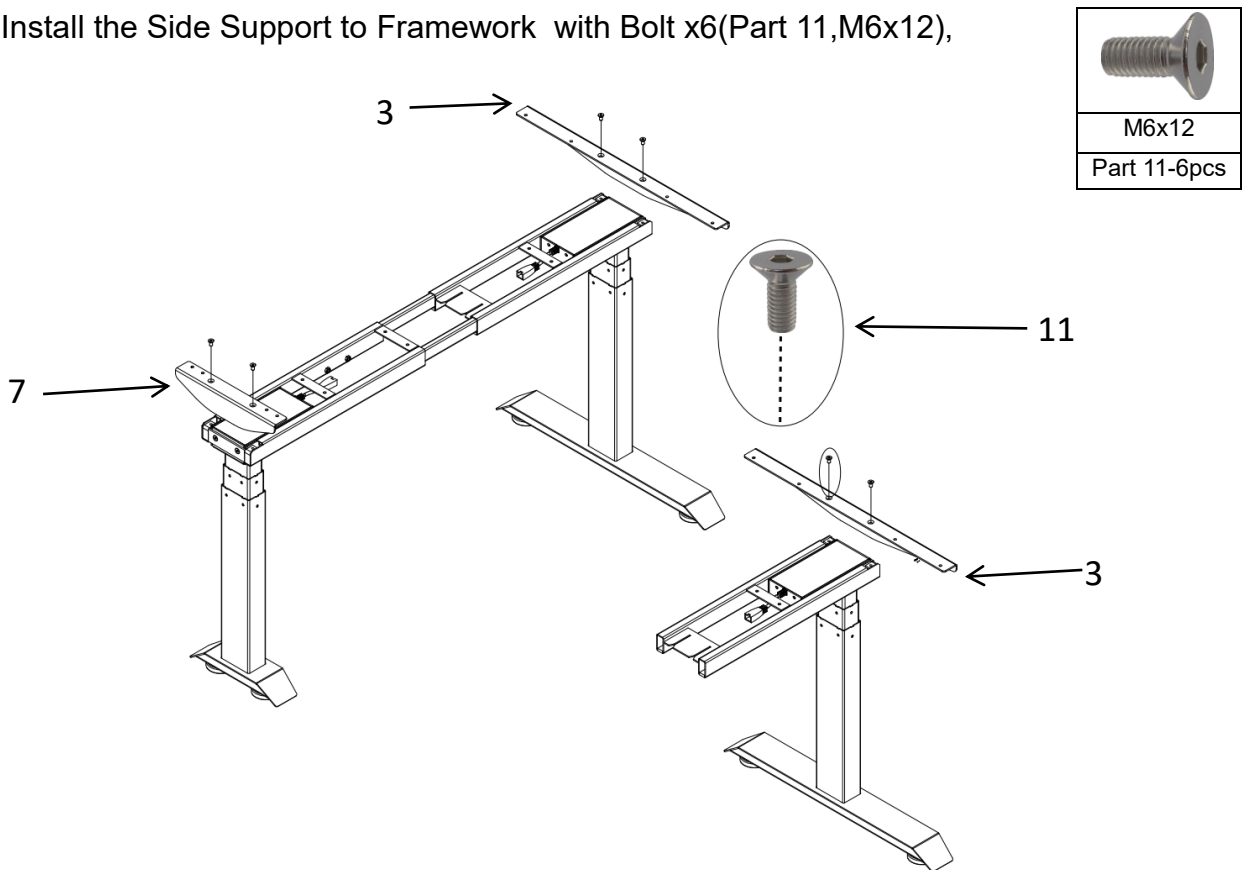

6. Insert extendable tube x2(Part 5) into 3rd leg framework.
7. Attach the one section of frame with the long foot and short foot to the single leg frame section with thumb screw x2 (Part 16)

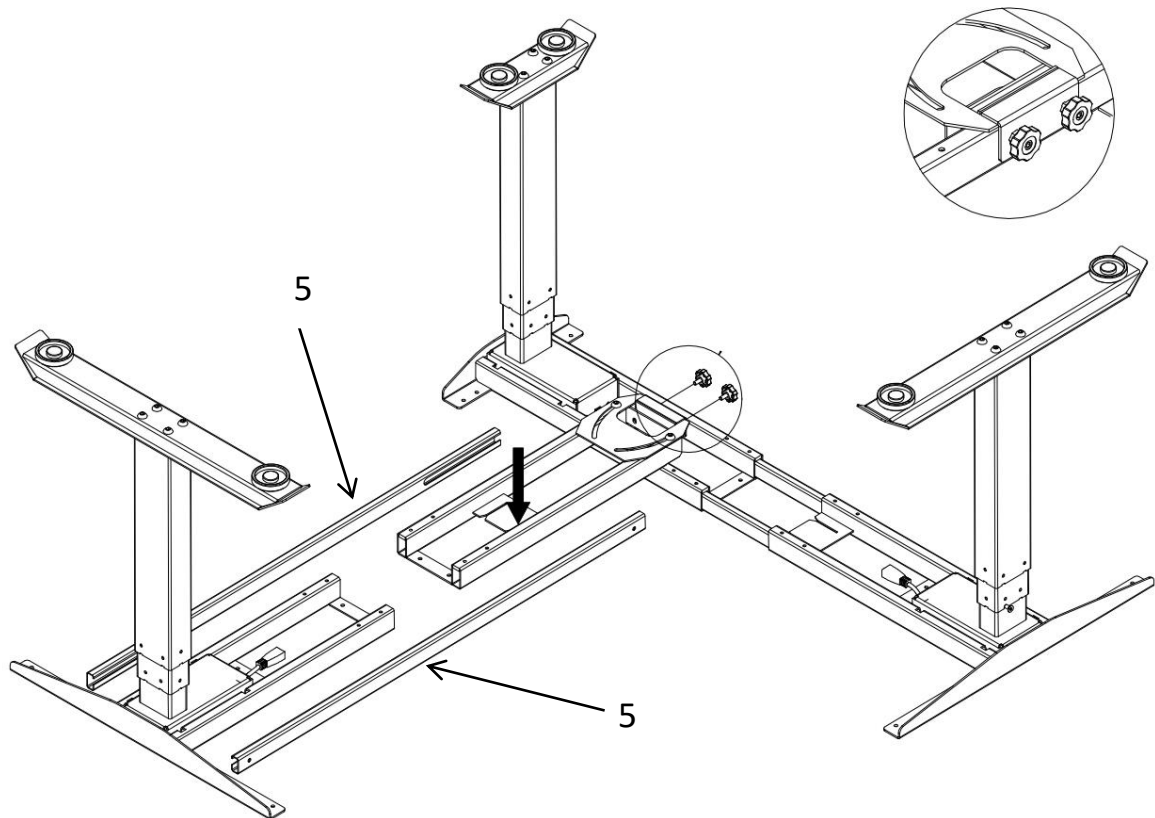

8. Centre bracket is locked in place with M6x10 bolts.
9. If the angle needs to be adjusted simply loosen the 2pcs M6x10 first,so that the corner could be adjusted from.
90° -120° tighten bolts to set proper angle.

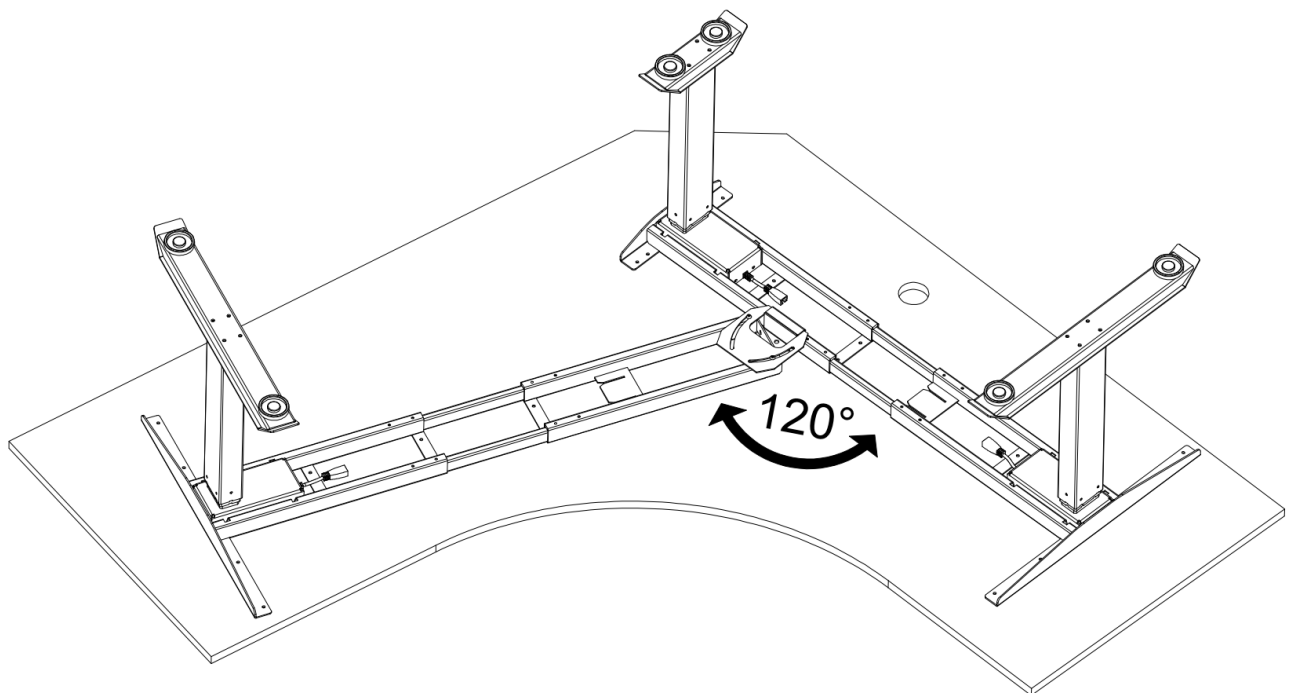
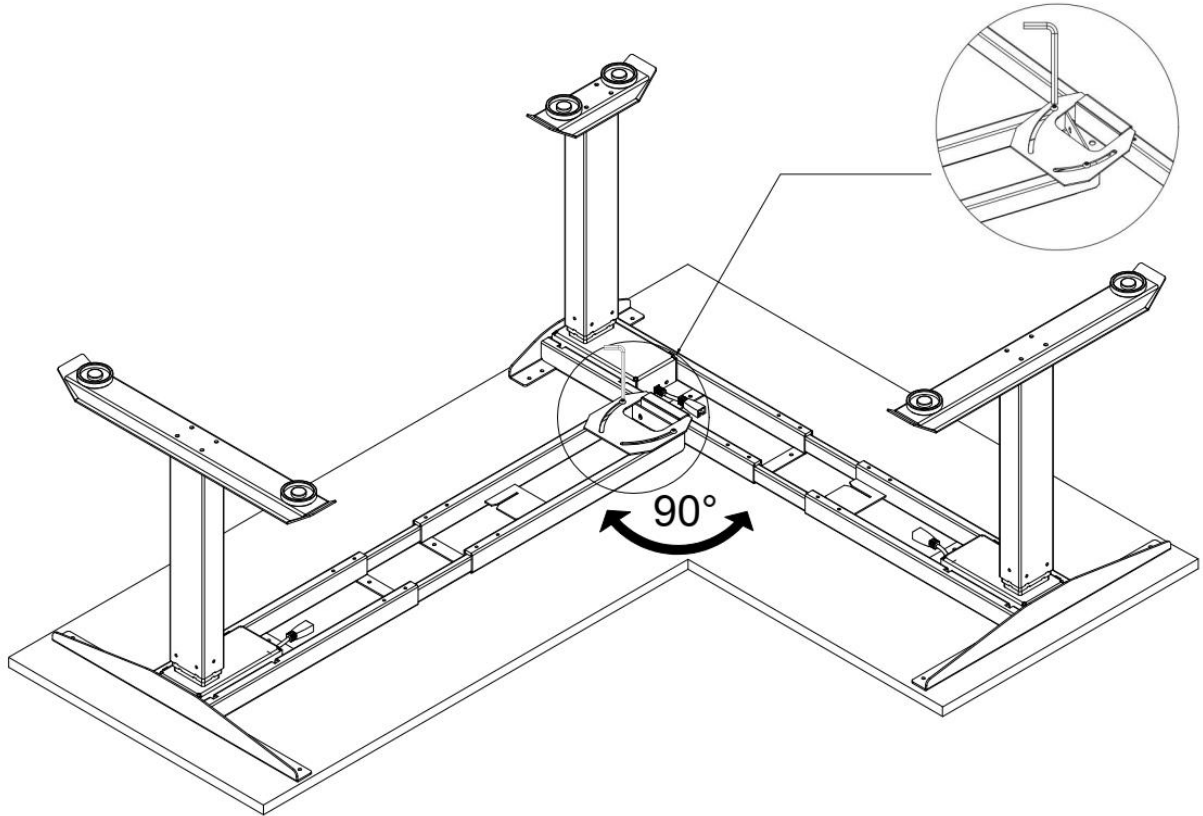

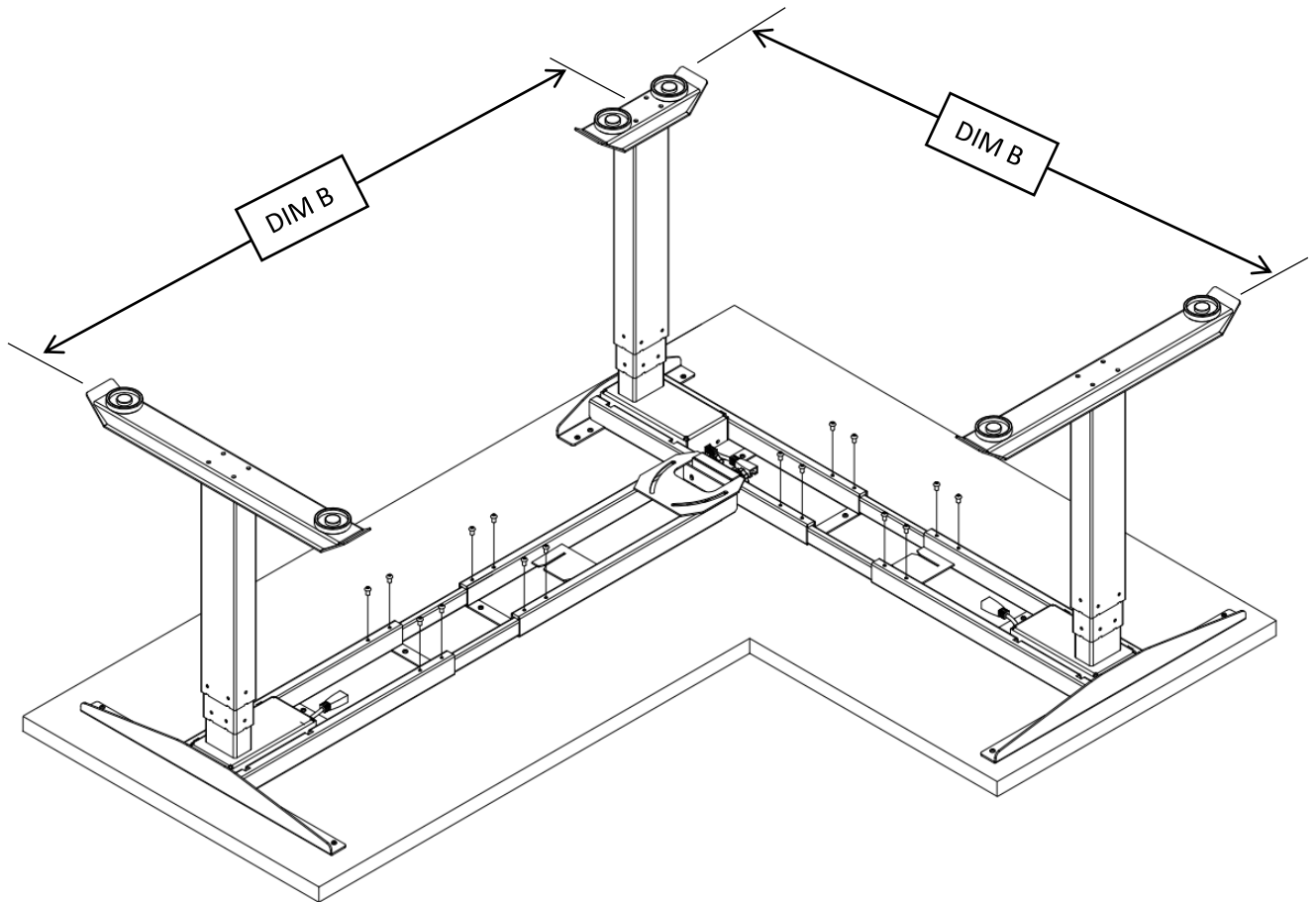
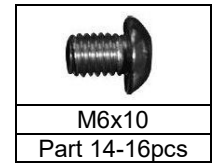

10. Set width of base(DIM B) according to width of table top(DIM A) Refer to grid below.

11. Tighten Bolt x16(Part 14,M6x10) to set the base frame to the correct width.



	Dimension	
	A	B
Nominal Width	Top Width	Base Width
83	83.5	72
77	77.5	72
71	71.5	69.5
59	59.5	57.5
47	47.5	45.5

12. Hang the Control box x1(Part 26) on the base.
13. Stick Rubber Bumper x 16(Part 12) on top of Lifting Column and Extendable Tube.
14. Install desktop.Position in the center of top as below picture.
15. Using Screw x27(Part 13,#12x3/4) to attach the base to the table top.
16. 3rd leg bracket need another Bolt x3(Part 15,1/4-20x3/4) to be fixed to table top.

	
#12x3/4	1/4-20x3/4
Part 13-27pcs	Part 15-3pcs

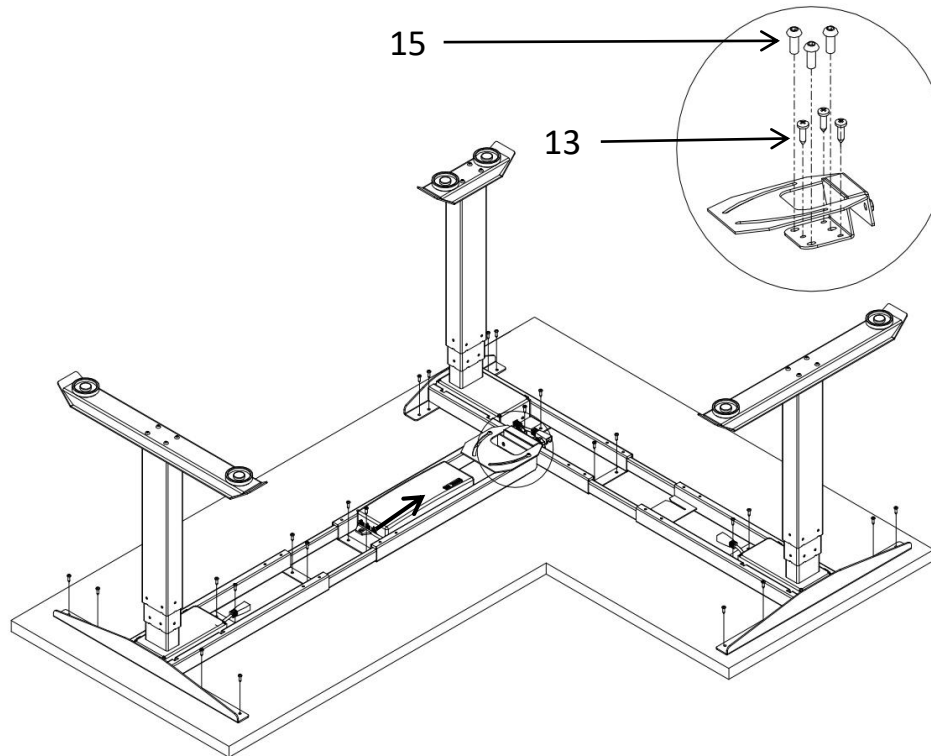

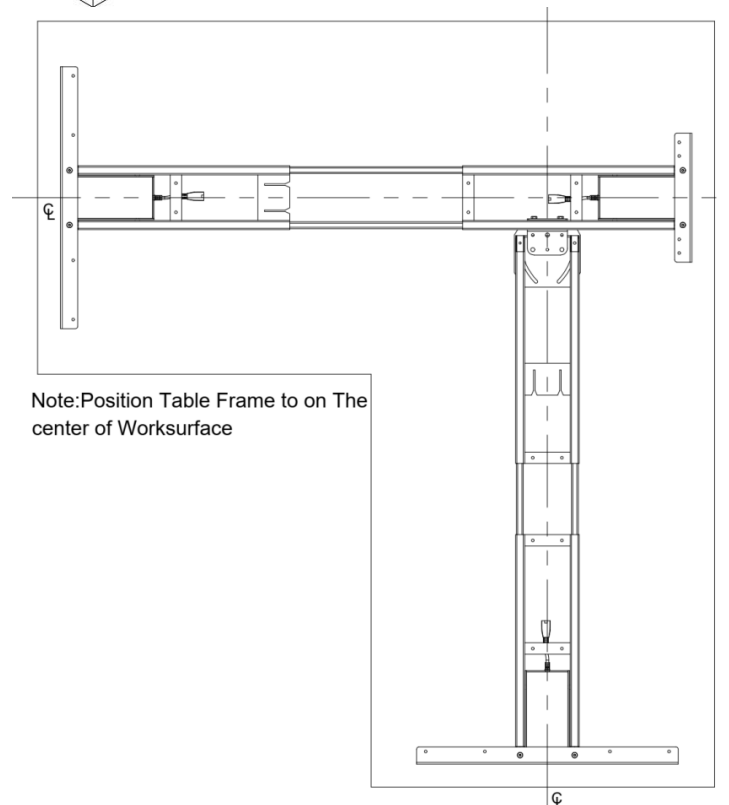

Rubber Bumper
Part 12-16pcs

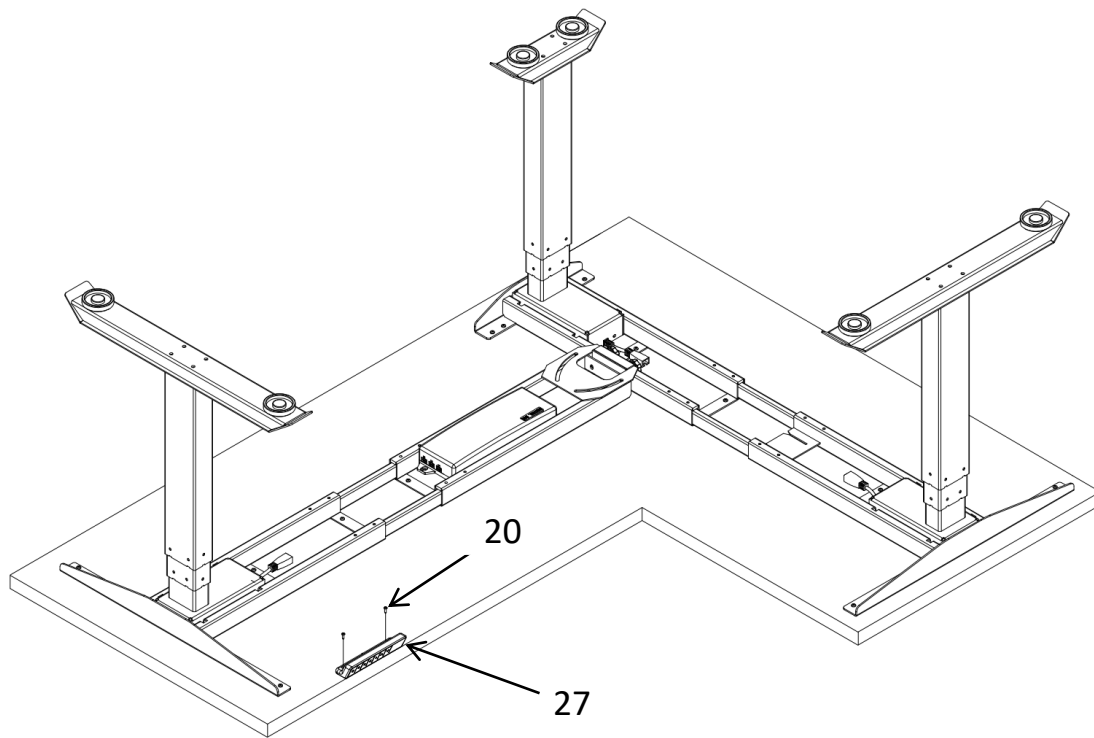
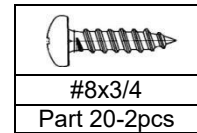

Note:Position Table Frame to on The center of Workspace

17. Install Handset x1(Part 27) with Screw x2(Part 20,#8x3/4).
Note:Cable Tie can be fixed under worksurface with #8x3/4



Connecting the Electrical Components

18. Attach Patch Cord x3(Part 25) to 6 pin connector on Control box (Part 26)
And 6 pin connector to Lifting Column x3(Part 2).
19. Attach Handset RJ45 connector (Part 27) to Control Box switch port(Part 26) .
20. Install the Power Cord(Part 24) to Control Box (Part 26).
21. Plug Power Cord into Power Supply. Initialize table by pressing and holding down the down button on the handset for 5 seconds. The handset will display "RES" to confirm the reset command.
22. Table is ready for use. Consult User instructions for more display and calibration options.

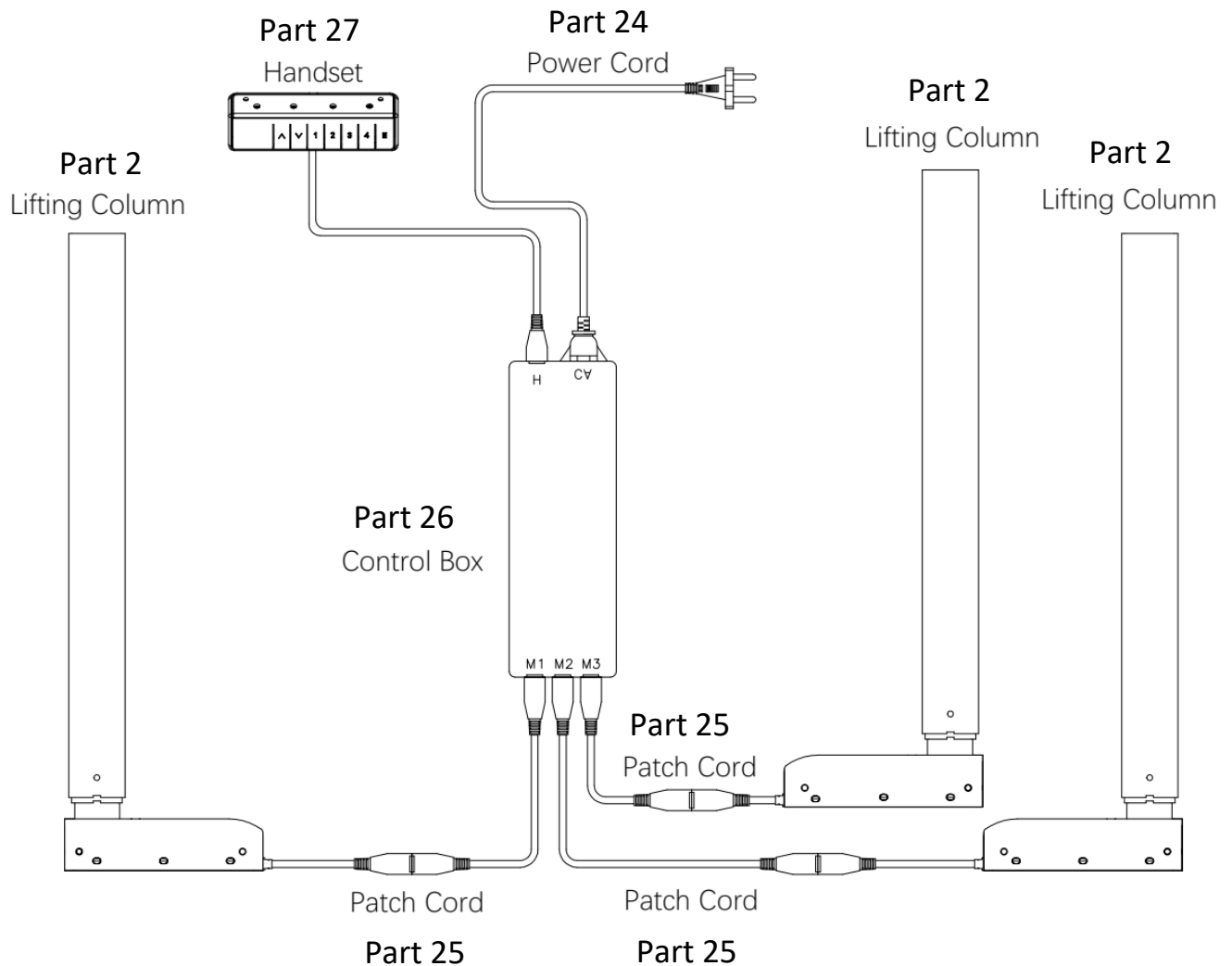



SAFETY NOTICE

Instability Hazard

Mobile items on casters such as flip tops, personal and movable tables of any type, and storage items of any type may present an instability hazard if not secured correctly while in use or storage. Flip-top tables or training tables of any type are inherently more unstable when folded. Tayco provides the following guidelines & warnings when using mobile products:

- Lock casters immediately after moving. Do not leave the casters unlocked when in use or storage.
- Motion may increase the instability of any item with casters. If the wheels hit an obstruction the table's forward momentum often causes overturn, especially if the item is not equipped with wheel extensions. Exercise strong caution while moving these items.
- Use caution when abrupt level changes in the floor are present (such as a doorway or room threshold) as caster failure or tipping may result.
- Do not stand, sit or lean on mobile items for support. They are not intended for this use and personal injury or property damage may result.
- Mobile units that feature height-adjustable elements must be lowered to the minimum compressed height when moving to prevent instability. It is also recommended the user remove all computer equipment or other accessories to prevent possible weight imbalance or damage to equipment.
- Failure to follow the guidelines above may result in property damage or personal injury.

Heavy Load

- Some products must be anchored to the wall to ensure stability & safety.
- It is the owner and installer's responsibility to ensure that the wall type and construction are of sufficient strength to carry loads of any wall-mounted products and their contents.
- Failure of the wall and anchors to support all imposed loads may result in property damage and/or personal injury.
- Tayco can provide the size and empty weight of its products only. A wall blocking is considered a building construction process, Tayco cannot provide recommendations in this respect and cannot be responsible for damage or injury that may occur as a result of improper installation and/or blocking.

Load Bottom Drawer First!

- Operate one drawer at a time.
- Units may tip if loaded incorrectly.
- Units should be attached to a wall or other furniture to reduce tipping hazards.
- Always load the heaviest files in the bottom drawer.

Adjusting the Start Height Display

1. Press & hold the 'S' button; 'S--' will blink on the keypad.
2. Press once on 'S' again to get to the adjustable features menu; the keypad will show '1Un'.
3. Press 7 times on the up arrow; the keypad will show '7SH'.
4. Press once on 'S'; the keypad will show 'Hib'.
5. Press once on 'S'; the keypad will show the minimum height of the table.
6. Press once on the up arrow; the keypad will show the previous height incremented with 0,4. (as an example, if the minimum height by default is 25.2, it would now show 25.6).
7. Press on 'S' as many times as you want until the display shows the desired height, by increments of 0,4.
8. Press once on 'S'; this confirms the new height to display. Wait 2 seconds before operating the table again. The table will now take into account the new height programmed when operating the table as usual.



SAFETY NOTICE

Instability Hazard

Mobile items on casters such as flip tops, personal and movable tables of any type, and storage items of any type may present an instability hazard if not secured correctly while in use or storage. Flip-top tables or training tables of any type are inherently more unstable when folded. Tayco provides the following guidelines & warnings when using mobile products:

- Lock casters immediately after moving. Do not leave the casters unlocked when in use or storage.
- Motion may increase the instability of any item with casters. If the wheels hit an obstruction the table's forward momentum often causes overturn, especially if the item is not equipped with wheel extensions. Exercise strong caution while moving these items.
- Use caution when abrupt level changes in the floor are present (such as a doorway or room threshold) as caster failure or tipping may result.
- Do not stand, sit or lean on mobile items for support. They are not intended for this use and personal injury or property damage may result.
- Mobile units that feature height-adjustable elements must be lowered to the minimum compressed height when moving to prevent instability. It is also recommended the user remove all computer equipment or other accessories to prevent possible weight imbalance or damage to equipment.
- Failure to follow the guidelines above may result in property damage or personal injury.

Heavy Load

- Some products must be anchored to the wall to ensure stability & safety.
- It is the owner and installer's responsibility to ensure that the wall type and construction are of sufficient strength to carry loads of any wall-mounted products and their contents.
- Failure of the wall and anchors to support all imposed loads may result in property damage and/or personal injury.
- Tayco can provide the size and empty weight of its products only. A wall blocking is considered a building construction process, Tayco cannot provide recommendations in this respect and cannot be responsible for damage or injury that may occur as a result of improper installation and/or blocking.

Load Bottom Drawer First!

- Operate one drawer at a time.
- Units may tip if loaded incorrectly.
- Units should be attached to a wall or other furniture to reduce tipping hazards.
- Always load the heaviest files in the bottom drawer.

Volley - 2 Leg Desk User Instructions

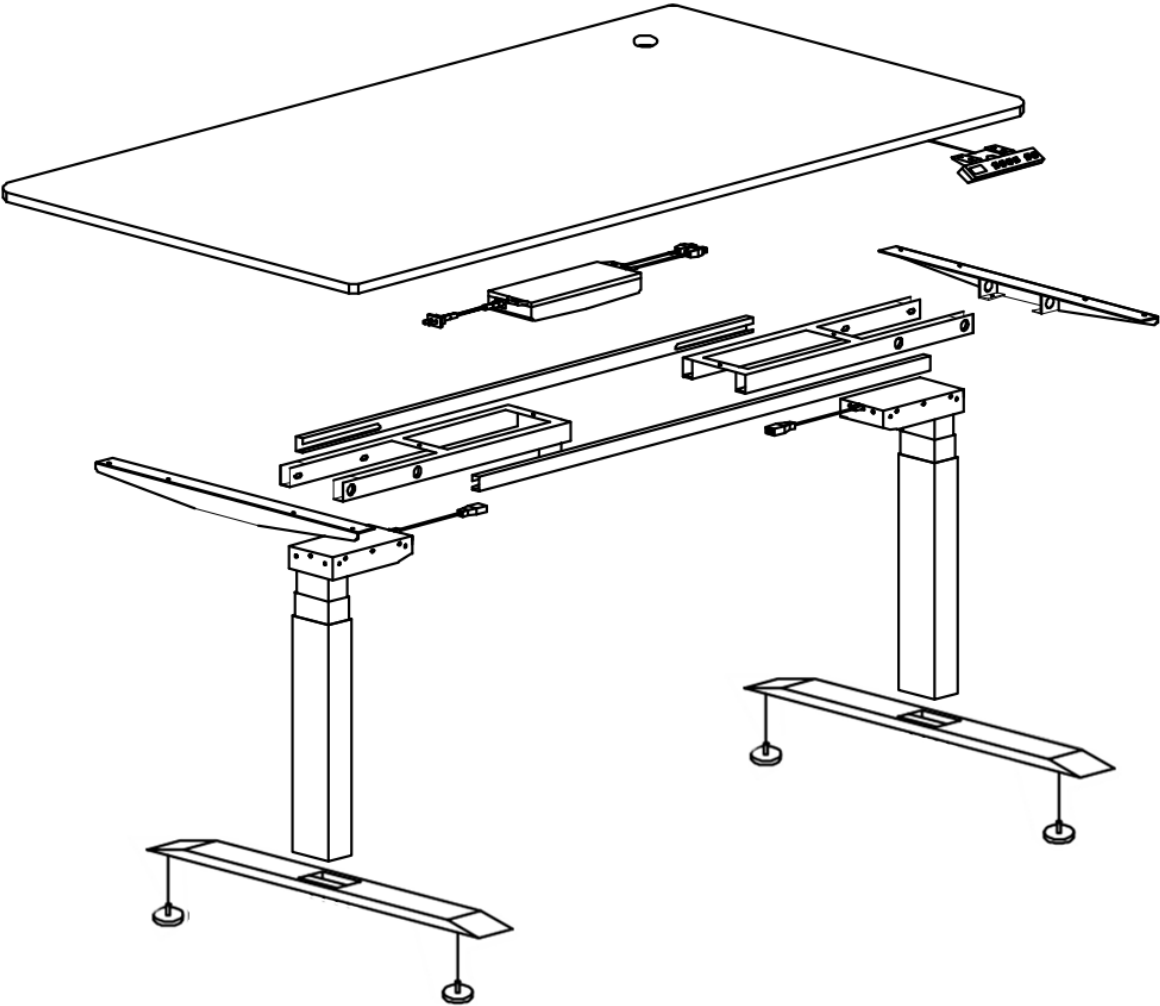

a. Parts list

1. Control Box ----- 1pc
2. Handset ----- 1pc
3. Power Cord ----- 1pc
4. Lifting Column ----- 2pcs
5. 1.5m Patch Cord ----- 2pcs

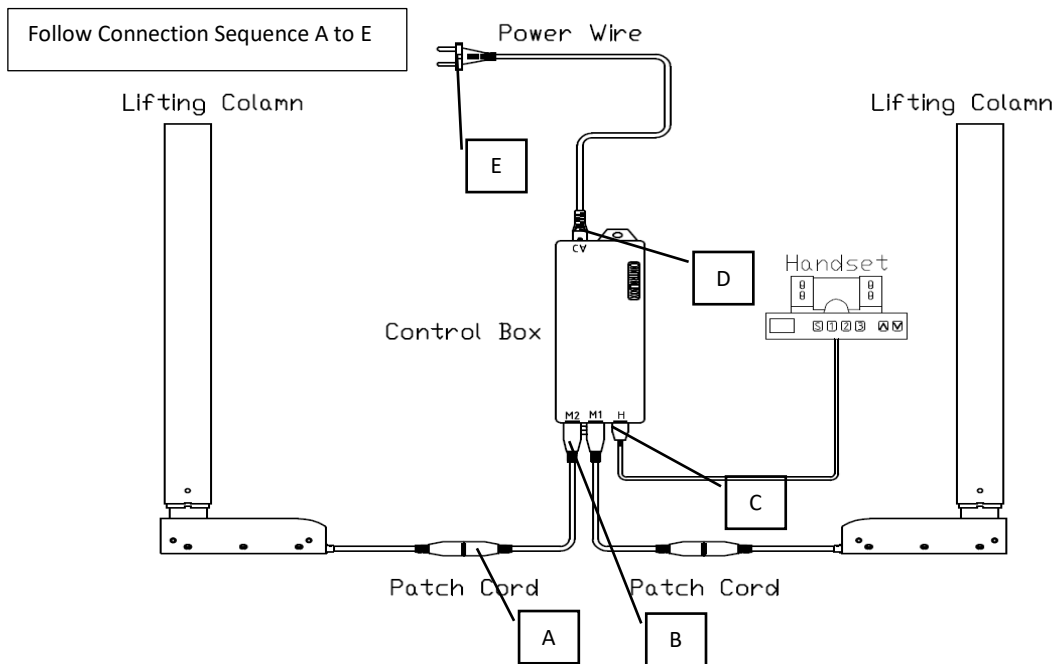

b. Technical Specifications

1. Input----- 110~240VAC
2. Output Power ----- 24VDC
3. Load Capacity ----- 300lbs
4. Speed ----- 30mm/s
5. Stroke ----- 644mm
6. Min Install Dimension ----- 550mm
7. Operation Temperature ----- 0-40°C
8. Duty Cycle ----- Max.10% or 2min on and 18min off

c. Direction for Use

1. Correctly connect the Control Box, Patch Cords Lifting Columns, Handset, Power Cord, in the sequence shown above. Note always power control box last!
2. Plug the power cord into 110~220VAC outlet The LCD display will show “PON” for seconds indicating a positive power connection system resetting.

After resetting the LCD display will display **21.6(INCH)**, reset finished.

Reset: (Initialization)

- Press and hold the down button, until handset display "RES" and then release button, The desk will begin to lower, until to the lowest height then slightly rise. Reset finished.
3. After reset, table can be operated normally. press and hold “Up” button to move the table in an upward direction. Display will show height of table. Release “Up” button at desired height.
 4. To lower table press and hold the “down” button. Display will show height of table. Release “Down” button at desired height.

Setting Memory Positions

Press and hold UP/DOWN button to desired height, press button M first, then press button 1, this height will be remembered by button 1.

Press and hold UP/DOWN button to another desired height, press button M, then press button 2, this height will be remembered by button 2.

Repeat steps above for position 3 and 4 .

After setting memory positions, press 1/2/3/4 button, desk will move to the stored position. At any time press “UP” and “DOWN” button. The motion will be stopped.

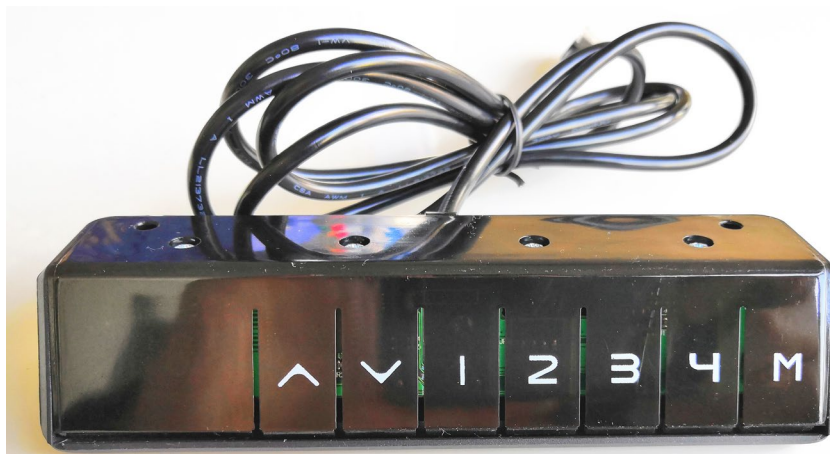

d. Trouble Shooting

If the LCD Controller displays error codes when raising or lowering the desk, a reset will be required.

1. Table must be reset before first use. If the lifting columns are at different heights, reset required follow reset instructions.
2. Motor error (E01/E02/E03/E04)
These error codes mean the control box can't detect motor hall plate signal, Or Control box detects one lifting column is over loaded. Adjust Load on table and retry

Alternatively

The patch cord connected with <M1/M2/M3 port has an error and needs to be reset. Should a reset fail to resolve the issue one or more motors may need to be replaced. Please contact Customer Service for assistance.

3. Control box temperature protection (HOT)
This indicates that the control box temperature is above 75°C or the system has been in continuous use for 2min or more. The lifting columns are locked out for up to 18mins as a safety precaution. Wait for control box to cool before resuming operation. The power cord can also be unplugged to accelerate this process.
4. Motors asynchronous (E06)
The lifting columns are asynchronous (height differential >10mm), faults have occurred with the motor or other components, reset required (Remove Load)
5. Overload protection (E07)
Desk overloaded. Reduce or remove load, then reset or wait for 3 seconds, it will recover.
6. Low Voltage protection (E08)
Power Voltage is too low for operation. Operation will resume when voltage returns to normal.
7. High Voltage protection (E09)
Power Voltage is too high. Operation will resume when voltage returns to normal.
8. Chip Error (E10)
Option a) Wait 30 - 40 seconds, code should disappear. If option a does not work unplug table, wait 30 seconds and restore power. Initialize table upon power up. Table should function normally

e. Warranty Notice

1. This product must be used in accordance with the install and user instructions.
2. Keep away from liquids, corrosives, gases and dusty environments.
3. Do not open any of the components, doing so will void any and all service support and manufacturer warranty.



General Navigation with Handset for Advanced Programming

"1" Button - Return to previous menu

"UP" / "DOWN" Button - Select menu



"M" Button - Confirm menu

f. Changing between cm and inch-1Un



Keep pressing Button "M" for 3 seconds, Handset will display "S---", release "M" press Button "M" again, code displayed "1Un". Press Button "M" to enter.

1. It will display **Si**, You can Press "M" button to preserve cm display and pls wait for 2 seconds it will display current height (cm).
2. After it displays **Si**, you can press Button "Up"/"Down" to change it to **in**, Press Button "M" to preserve Inch display and pls wait for 2 seconds it will display current height (Inch).

g. Setting Handset display brightness-2br

1. Press and hold "M" button for 3 seconds. Handset will display "S---", then release "M". Press Button "M" again to enter the code "1Un" will then appear.
2. Press button "Up"/"Down" to be 2br.
Then press button "M" to enter, this will display current display brightness level (L/H) 
L:Means low brightness, :Means normal brightness, H:Means high brightness.
3. Press button "Up"/"Down" to select your favourite brightness level, then press button "M" to preserve and quit, pls wait for 2 seconds and it will display current height.

h. Adjusting Sound-3bE

1. Press and Hold "M" button for 3 seconds. Handset will display "S---", release "M"
Press Button "M" again to enter the code "1Un" will then appear.
2. Press button "Up"/"Down" to be "3bE",
Then press button "M" to enter, this will display current sound situation (OFF/).
OFF:Means handset has no sound, ON:Means handset has sound.
3. Press button "Up"/"Down" to select OFF or , then press button "M" to preserve and quit, pls wait for 2 seconds and it will display current height.

i. Adjust upward sensitivity-4Fu

1. Press and hold "M" button for 3 seconds. Handset will display "S---", release. Press Button "M" again to enter the code "1Un" will then appear.
2. Press button "Up"/"Down" to be "4Fu", Then press button "M" to enter, this will display current upward sensitivity level (L5). We have 9 levels of upward sensitivity, from L1 to L9, L1 is the most sensitivity, L9 is the least sensitivity. L5 is our factory setting upward sensitivity.
3. Press button "Up"/"Down" to select your favourite upward sensitivity level, then press button "M" to preserve and quit, pls wait for 2 seconds and it will display current height.

j. Adjust downward sensitivity-5Fd

1. Press and hold “M” button for 3 seconds. Handset will display “S---”, release. Press Button “M” again to enter the code “1Un” will then appear.
2. Press button “Up”/”Down” to be “5Fd”.
Then press button “M” to enter, this will display current upward sensitivity level (L5).
We have 9 levels of upward sensitivity, from L1 to L9,L1 is the most sensitivity,L9 is the least sensitivity.L5 is our factory setting upward sensitivity.
3. Press button “Up”/”Down” to select your favourite upward sensitivity level, then press button “M” to preserve and quit, pls wait for 2 seconds and it will display current height.

k. Adjust Vibration Sensitivity-6FS

1. Press and hold “M” button for 3 seconds. Handset will display “S---”, release. Press Button “M” again to enter the code “1Un” will then appear.
2. Press button “Up”/”Down” to be “6FS”,Then press button “M” to enter, this will display current vibration sensitivity level (L5).We have 9 levels of vibration sensitivity, from L1 to L9,L1 is the most sensitivity,L9 is the least sensitivity.L5 is our factory setting vibration sensitivity.
3. Press button “Up”/”Down” to select your favourite vibration sensitivity level, then press button “M” to preserve and quit, pls wait for 2 seconds and it will display current height.

l. Adjust the lowest height display and height range-7SH

1. Press and hold “M” button for 3 seconds. Handset will display “S---”, release. Press Button “M” again to enter the code “1Un” will then appear.
2. Press button “Up”/”Down” to be “7SH”,Then press button “M” to enter, this will display H, b , you also can press button “Up”/”Down”, so that it will display L, L , and L, H .

H, b :Mean to set the lowest position display height.
 L, L

:Mean to set a new lowest position
L, H:Mean to set a new highest position

3. Press button “Up”/”Down” to be H, L, Then press button “M” to enter, will display current lowest height, you can Press button “Up”/”Down” to adjust the lowest height display, then press button “M” to preserve and quit, pls wait for 2 seconds and it will display new lowest height.
4. Press button “Up”/”Down” to be L, L, Then press button “M” to enter, will display current lowest height, you can Press button “Up” set a new lowest position, then press button “M” to preserve and quit, pls wait for 2 seconds and it will display height. New Lowest position finished setting.
5. Press button “Up”/”Down” to be L, H, Then press button “M” to enter, will display current highest height, you can Press button ”Down” to set a new highest position, then press button “M” to preserve and quit, pls wait for 2 seconds and it will display height. New Highest position finished setting.
6. After setting, desk can only motion between new lowest position and new highest position.

m. Switching between modes-8Hc

1. Press and hold “M” button for 3 seconds. Handset will display “S---”, release. Press Button “M” again to enter the code “1Un” will then appear.
2. Press button “Up”/”Down” to be “8Hc”, Then press button “M” to enter, this will display current mode:”001”.you also can press button “Up”/”Down”, so that it will display ”002”.

We have two modes for your choosing.

“001” mode: You need to keep pressing up or down button so that desk will motion.

“002” mode: You only need to press one time up or down button, the desk will move, click press any button the motion will be stopped.

3. Press button “Up”/”Down” to select your favourite mode(001 or 002), then press button “M” to preserve and quit, pls wait for 2 seconds and it will display current height.

n. Adjust time reminder-9St

1. Press and hold "M" button for 3 seconds. Handset will display "S---", release. Press Button "M" again to enter the code "1Un" will then appear
2. Press button "Up"/"Down" to be "9St", Then press button "M" to enter, this will display 0.0H. (Mean no time reminder, H mean hour)
3. Press button "Up"/"Down" to select your favourite reminder time (Like 1.5H mean 1.5hour), then press button "M" to preserve and quit, pls wait for 2 seconds and it will display current height.

Note:

When handset time reminder beep, press any button, the beep will disappear. The time reminder beep will last for 30 seconds for 1 time, if no pressing any button.

o. Adjust bounce height-10H

1. Press and hold "M" button for 3 seconds. Handset will display "S---", release. Press Button "M" again to enter the code "1Un" will then appear
2. Press button "Up"/"Down" to be "10H", Then press button "M" to enter, this will display current bounce height.
3. Press button "Up"/"Down" to set a favourite bounce height, then press button "M" to preserve and quit, pls wait for 2 seconds and it will display current height.

p. Restore factory Settings-11r

1. Press and hold "M" button for 3 seconds. Handset will display "S---", release. Press Button "M" again to enter the code "1Un" will then appear
2. Press button "Up"/"Down" to be "11r", press button "M" to enter, **F r t** will flash.
3. Then press button "M" to preserve and quit, **F r t** will stop flashing and wait for 2 seconds it will display current height.

q. Fatigue test mode-12d

1. Press and hold "M" button for 3 seconds. Handset will display "S---", release. Press Button "M" again to enter the code "1Un" will then appear

2. Press button “Up”/”Down” to be “12d”,Then press button “M” to enter.
It will appear **PH_** ,Press 5 times button “1” continuously, you can enter into fatigue mode selecting menu. There will be 5 modes for your choosing.

OFF:No fatigue test.

51:Level 1 fatigue test, continue working, no stop.

52:Level 2 fatigue test, Upward and Downward 1 time then rest for 4 minutes.

53:Level 3 fatigue test, Upward and Downward 1 time then rest for 6 minutes.

54:Level 4 fatigue test, Upward and Downward 1 time then rest for 10 minutes.

3. Pls press “up” and “down” to select your favourite fatigue mode, Then press button “M” to preserve.
4. You can press “UP” button to begin fatigue test, also you can quit the fatigue test by unplugging the power cord.

r. Handset Lock

1. Keep pressing “Up” and “Down” button for 5 seconds, Handset will lock.
2. Keep pressing “Up” and “Down” button for 5 seconds, Handset will be unlocked.



SAFETY NOTICE

Instability Hazard

Mobile items on casters such as flip tops, personal and movable tables of any type, and storage items of any type may present an instability hazard if not secured correctly while in use or storage. Flip-top tables or training tables of any type are inherently more unstable when folded. Tayco provides the following guidelines & warnings when using mobile products:

- Lock casters immediately after moving. Do not leave the casters unlocked when in use or storage.
- Motion may increase the instability of any item with casters. If the wheels hit an obstruction the table's forward momentum often causes overturn, especially if the item is not equipped with wheel extensions. Exercise strong caution while moving these items.
- Use caution when abrupt level changes in the floor are present (such as a doorway or room threshold) as caster failure or tipping may result.
- Do not stand, sit or lean on mobile items for support. They are not intended for this use and personal injury or property damage may result.
- Mobile units that feature height-adjustable elements must be lowered to the minimum compressed height when moving to prevent instability. It is also recommended the user remove all computer equipment or other accessories to prevent possible weight imbalance or damage to equipment.
- Failure to follow the guidelines above may result in property damage or personal injury.

Heavy Load

- Some products must be anchored to the wall to ensure stability & safety.
- It is the owner and installer's responsibility to ensure that the wall type and construction are of sufficient strength to carry loads of any wall-mounted products and their contents.
- Failure of the wall and anchors to support all imposed loads may result in property damage and/or personal injury.
- Tayco can provide the size and empty weight of its products only. A wall blocking is considered a building construction process, Tayco cannot provide recommendations in this respect and cannot be responsible for damage or injury that may occur as a result of improper installation and/or blocking.

Load Bottom Drawer First!

- Operate one drawer at a time.
- Units may tip if loaded incorrectly.
- Units should be attached to a wall or other furniture to reduce tipping hazards.
- Always load the heaviest files in the bottom drawer.

02/2023

Electrical Connection Sequence

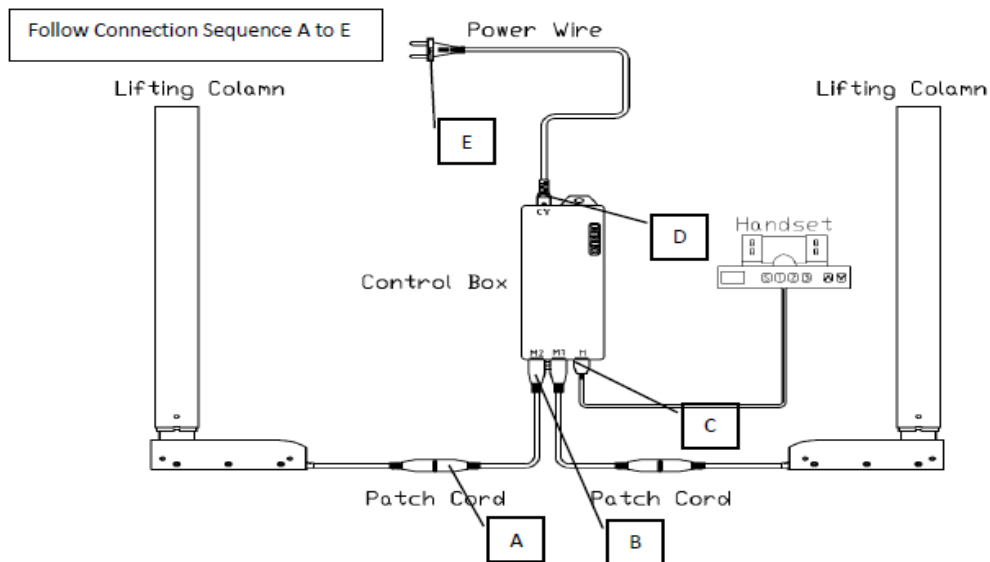

Reset: (Initialization)

Press and hold the down button, until handset display "RES" and then release button. The desk will begin to lower, until to the lowest height then slightly rise. Reset finished.

3. After reset, table can be operated normally. press and hold "Up" button to move the table in an upward direction. Display will show height of table. Release "Up" button at desired height.
4. To lower table press and hold the "down" button. Display will show height of table. Release "Down" button at desired height.

Description of Problem	Solution 1	Solution 2	Solution 3
Lifting column will not go up or down	Verify that power supply has power by testing with a plug in lamp or other device. Check to ensure that connections were made in the proper sequence as noted on page 1. Try disconnecting all and re-connect in the proper sequence. Test again	Check pins on the lift column lead to make sure no pins were damaged. Check pins on the – control box to ensure that pins are not damaged	Check wires to ensure that they are not pinched or damaged - Pinched or damaged wires can cause the table to work intermittantly, stop unexpectedly, or fail to function
Lifting column will not go up or down	Disconnect AC power and motor cables. Try changing the position of the motor cables (change motor cable ports), initialize the table and retest		

Description of Problem	Solution 1	Solution 2	Solution 3
Leg makes a loud noise when raising or lowering	Inspect leg for physical damage. Contact BRC customer service for information pertaining to leg service or change		
Programmable switch with Digital readout is blank when connected	Disconnect AC power. Disconnect switch cable and motor cables from the control box. Wait 10 minutes with power off. Reconnect cables in this sequence. (1) Motor cables to control box. (2) Switch cable to control box. (3) Connect AC power to control box. (4) follow initialization process as outlined above	Repeat steps outlined in solution 1. Ensure wait time is adhered to, and that connection sequence is correct.	Programmable switch remains blank after solution 1. Contact BRC customer service.
Leg Chatter on downward travel	If programmable switch is being used on the desking system, report if an error code is being displayed on the switch. See list of error codes below for causal factor and solution.	(a) Test table with top – record results (b) Test table with top – loaded with weight – record results (c) Test table base with no top – record results. If chatter exists in condition (a) Contact BRC customer service for information pertaining to leg service or change	

Error Codes

If the LCD Controller displays error codes when raising or lowering the desk, a reset will be required.

1. Table must be reset before first use. If the lifting columns are at different heights, reset required follow reset instructions.
2. Motor error (E01/E02/E03/E04)
These error codes mean the control box can't detect motor hall plate signal, Or Control box detects one lifting column is over loaded. Adjust Load on table and retry

Alternatively
The patch cord connected with <M1/M2/M3 port has an error and needs to be reset. Should a reset fail to resolve the issue one or more motors may need to be replaced. Please contact Customer Service for assistance.
3. Control box temperature protection (HOT)
This indicates that the control box temperature is above 75°C or the system has been in continuous use for 2min or more. The lifting columns are locked out for up to 18mins as a safety precaution. Wait for control box to cool before resuming operation. The power cord can also be unplugged to accelerate this process.
4. Motors asynchronous (E06)
The lifting columns are asynchronous (height differential >10mm), faults have occurred with the motor or other components, reset required (Remove Load)
5. Overload protection (E07)
Desk overloaded. Reduce or remove load, then reset or wait for 3 seconds, it will recover.
6. Low Voltage protection (E08)
Power Voltage is too low for operation. Operation will resume when voltage returns to normal.
7. High Voltage protection (E09)
Power Voltage is too high. Operation will resume when voltage returns to normal.
8. Chip Error (E10)
Option a) Wait 30 - 40 seconds, code should disappear. If option a does not work unplug table, wait 30 seconds and restore power. Initialize table upon power up. Table should function normally



SAFETY NOTICE

Instability Hazard

Mobile items on casters such as flip tops, personal and movable tables of any type, and storage items of any type may present an instability hazard if not secured correctly while in use or storage. Flip-top tables or training tables of any type are inherently more unstable when folded. Tayco provides the following guidelines & warnings when using mobile products:

- Lock casters immediately after moving. Do not leave the casters unlocked when in use or storage.
- Motion may increase the instability of any item with casters. If the wheels hit an obstruction the table's forward momentum often causes overturn, especially if the item is not equipped with wheel extensions. Exercise strong caution while moving these items.
- Use caution when abrupt level changes in the floor are present (such as a doorway or room threshold) as caster failure or tipping may result.
- Do not stand, sit or lean on mobile items for support. They are not intended for this use and personal injury or property damage may result.
- Mobile units that feature height-adjustable elements must be lowered to the minimum compressed height when moving to prevent instability. It is also recommended the user remove all computer equipment or other accessories to prevent possible weight imbalance or damage to equipment.
- Failure to follow the guidelines above may result in property damage or personal injury.

Heavy Load

- Some products must be anchored to the wall to ensure stability & safety.
- It is the owner and installer's responsibility to ensure that the wall type and construction are of sufficient strength to carry loads of any wall-mounted products and their contents.
- Failure of the wall and anchors to support all imposed loads may result in property damage and/or personal injury.
- Tayco can provide the size and empty weight of its products only. A wall blocking is considered a building construction process, Tayco cannot provide recommendations in this respect and cannot be responsible for damage or injury that may occur as a result of improper installation and/or blocking.

Load Bottom Drawer First!

- Operate one drawer at a time.
- Units may tip if loaded incorrectly.
- Units should be attached to a wall or other furniture to reduce tipping hazards.
- Always load the heaviest files in the bottom drawer.